



Published Monthly

Hard Copy Distribution 400 - Website : 6,000 average/month

Windellama, Oallen, Nerriga, Bungonia, Mayfield, Quialigo, Lake Bathurst, Bungendore & Tarago

## Windellama Public School P & C FIREWORKS NIGHT & AUCTION

Long Weekend Family Fun!

11 June

Windellama Hall

Food, Entertainment, Show Bags and Fireworks  
see page 5



### *And more inside...*

- \* Social and Gardening Clubs Activities
  - \* Local stock agents & tradespeople
  - \* Local markets, arts & crafts
- \* Landcare & environmental news
  - \* SES and RFS advice and reports
  - \* Historical memoirs
- \* Theatre & cultural events
- \* Classified Ads for sale & bargain deals

◇ BURNING OFF? - Fire season finished 31 March- regulations still apply.

## Coming Events...

**Annual Subscriptions** - please send your details and **\$30** (cheques payable to 'Windellama News') to cover the annual cost of postage.

All cheques please post to:

**The Secretary, PO Box 705, Goulburn. 2580**

\* Unpaid subscriptions will be cancelled after one month

If you have any short articles, anecdotes, or something else interesting about yourself, your family, or the community; please write it down and drop it in our letterbox at the Hall. We will edit it and publish it in the Windellama News.

**A LOCKED POSTAL BOX IS AT THE FRONT OF THE HALL, 3444 OALLEN FORD RD, IN THE STONE WALL FOR THE COLLECTION OF ITEMS FOR PUBLICATION**

**Items left in the box after the deadline will not be collected or included in the News**

Articles, adverts, etc may also be sent by email to:

[newswindellama@gmail.com](mailto:newswindellama@gmail.com)

**Adverts sent by email will not be inserted unless payment is received by the deadline.**

### Our Policy on Receipts

The Windellama News makes out a receipt for all advertising payments made to the paper. We don't post out receipts to save cost and we assume that the appearance of the advertisement in the paper could normally be taken as proof of payment. If you require a posted receipt please include a stamped self-addressed envelope with your payment.

It would be greatly appreciated if anyone sending money to the Windellama News would include their name and address and a note saying what it was for and put it in a sealed envelope. This would avoid a lot of confusion and uncertainty.

### Notice to advertisers, article submitters & readers

The Windellama News is published and authorised by the Windellama Progress Association Inc. Whilst every care has been taken in the production of the News & publishing to the web page on the community website, the editor takes no responsibility for any inaccuracies, errors or omissions. All such contributors by forwarding advertising, notices, & articles, agree to indemnify the publisher & warrant that the material is accurate & neither deceptive nor misleading, in breach of copyright, defamatory or in breach of any other laws & regulations.

The responsibility for advertisements complying with the Trade Practices Act lies with the person, company or agency submitting such for publication. Original material appearing in this newsletter is copyright. It may be reproduced in part or in whole for the benefit of the community, provided that the source of the material is fully acknowledged. If you have any queries about using material from the Windellama News, please contact the editor.

### June

- 3 Progress Meeting 10.00 am**
- 4 Historical Society Meeting**
- 11 School Auction & Fireworks**
- 11 NPSA Cake Stall & Sausage Sizzle at Nerriga Hall**
- 25 Brigade AGM**
- 30 Garden Club Pot Luck Lunch**

### July

### August

- 13 Can Assist Cake Auction**

## Inside this Issue.....

Community Noticeboard	3
Windellama Fireworks Night	5
Windellama Garden Club	7
Windellama Fire Brigade	9
Historical by Tom Bryant	11
In Your Garden	13
Windellama SES, First and CFR	15
Willowglen Gardeners	17
WIRES	19
School News	23
Nerriga	25
Nerriga Gardeners	27
Historical Society	31
Church Information	32
Classified Ads	33/34
Community Information	35
June Calendar	36

**DEADLINE FOR ALL ISSUES IS THE 20TH OF THE PRECEEDING MONTH**

**YOUR WINDELLAMA NEWS IS PRINTED BY BUSINESS REQUISITES, GOULBURN**

# Community Notice Board

## Our Advertising Charges

Classifieds - Personal (maximum 2 lines)	<b>FREE</b>	
	<b>Month</b>	<b>Year 11 issues)</b>
Small advertisement (business card size)	\$ 6.50	\$ 65.00
Quarter page advertisement	\$12.00	\$120.00
Half page advertisement	\$25.00	\$250.00
Full page advertisement	\$50.00	\$500.00
Double page discount	\$90.00	

Inserts - \$40.00 for 400 inserts into hard copies

Typesetting of adverts: \$50

### PAYMENT:

**Cheques:** payable to *Windellama News*

**PO Box 705, Goulburn. 2580**

**Direct Deposit or EFT:** IMB Ltd; BSB 641.800;  
A/c 200045794 with Name & advert as detail

*\* Unpaid adverts will be cancelled after one month*

*\* All advertising copy must be accompanied with payment*

All advertising enquiries to

Christine Woodcock

**Can you tell us about a situation where local knowledge and expertise helped you out?  
Let us know and we will publish it in our next newsletter.**

We are looking for a driver to deliver the Windellama News on the Spa Road run. If you can spare an hour or two each month, why not join our delivery team?

Call Christine on 4844 7275

Next Progress Association Meeting is on Friday 3rd June at 10.00 am. New members always welcome

**WANTED— Work with Windellama News Team** as an EDITOR. Knowledge of Microsoft Publisher an advantage, but not essential. Work from home and make your own hours. Volunteer position. Call Lyn Jones (4844 5843) or Christine Woodcock (4844 7275) or Gayle Stanton (4844 5156)

## Craft @ Windellama Hall

We meet from the second Tuesday of the month 1—4 pm.

For more information please call Irene Turner on 48445 214.

## Rainfall Stats



15 April to 15 May

**Rosewood**, Windellama Road, Windellama

40/ 6 days

**Gar-Den**, Oallen Ford Rd, Oallen

/ days

**Johnno's Store**, Oallen Ford Rd, Bungonia

/ 5 days

**Tarkierelea**, Fernleigh Close, Windellama

ml / days

**The W's**, Readers Road, Quialigo

47 ml/ days

**Corang Cottage**, Braidwood Road Nerriga

33.65 ml / 9 days

**Tarago Village**

ml / days

**Nerrimunga Creek Rd**, Windellama

ml/ days

**Willy Weather**

ml / days

**NPSA is holding their first Cake Stall and Sausage Sizzle at Nerriga Hall on Saturday June 11 - Queens Birthday**

**Long Weekend. Hope to see you there**



# Windellama

PLUMBING & HOT WATER

**Brett Gallagher 0410 377 577**

**bgallagherplumbing@gmail.com**

**RESIDENTIAL | COMMERCIAL | INDUSTRIAL**

- PLUMBING
- DRAINAGE
- GAS FITTING
- LP | NATURAL GAS
- HOT WATER MAINTENANCE
- SEWER
- STORM WATER
- CIVIL DRAINAGE
- CCTV CAMERA INSPECTIONS
- BACKFLOW PREVENTION
- TMV TEST
- EXCAVATION
- WATER JET DRAIN CLEANING
- PROGRAMMED MAINTENANCE SPECIALIST

**(02)4844 5395 • 3654 Oallen Ford Rd, Windellama NSW 2580**



**WINDELLAMA PUBLIC SCHOOL P&C**

**FIREWORKS NIGHT and AUCTION**  
**at WINDELLAMA HALL**

**SATURDAY 11 JUNE 2016**



**AUCTION**

(all new goods)

Starting at approximately 2.00 pm

Bring your money and pick up a bargain!

Many items and vouchers donated by Goulburn businesses.

Come along and look at all the items and have a bid!

Come and have some fun with our fantastic auctioneer!!!!



<https://www.facebook.com/events/>



**FIREWORKS**  
from  
**FOTI**

approximately  
6.00 – 6.15 pm

**DELICIOUS FOOD**

Soup or choice of meat with  
gravy on rolls

**CAKES, SLICES & COLD DRINKS**

**PICK-a-JAR**

**GUM**

**BOOT**

**THROW**

**CHOCOLATE  
WHEEL**

**ENTERTAINMENT  
FOR  
CHILDREN**

**SHOW BAGS &  
GLOW PRODUCTS**

**FACE  
PAINTING**



**ADMISSION**

\$15 per Family (2 Adults & 2 children)

\$ 6 per Adult & Secondary Students

\$ 4 per Primary Student & Pensioners

**HOT DRINKS**

from

**KEEN 4 CAFFEINE**



# ~~The Loaded Dog Hotel~~



Tarago EST 1848

Hotellers: Nicole & Mark Ryan [www.loadeddoghotel.com](http://www.loadeddoghotel.com) 02 4849 4499

1 Wallace Street TARAGO NSW 2580 | 02 4849 4499 | [loadeddoghoteltarago@gmail.com](mailto:loadeddoghoteltarago@gmail.com)

## LIVE MUSIC @ THE DOG

June 18th

**Luke O'Shea**

July 15th

**Steve Deal**

Social Darts 7.30pm  
every fortnight

Come alone or bring a  
team



All  
welcome

Bingo @ The Dog  
11am on 1st  
Wednesday of the  
month



**Free Half Time  
Hotdogs**

Game 1 - June 1st

Game 2 - June 22nd

## The Dog Bistro

Nicole's Fish'n'chips Thursdays 6 - 8pm \$7.50

Home made Pizza all day every day, eat in or take away

### Bistro Hours:

Friday & Saturday 6pm - 8:30 pm

Sunday 6pm - 8:00pm

Lunches 7 days 12 - 2pm

# Windellama Garden Club Incorporated

Hi Everyone!

Another busy month has gone and we are now sliding toward the start of winter.

On the 6<sup>th</sup> May the club had a car trip to Robertson for two garden tours. What wonderful gardens they were. Two very different types of garden and what a difference when you have good soil. The things that they had growing were amazing. Unfortunately due to our climate it would be impossible to grow the same things here.

The Club would very much like to thank Dawn Wilson and her generosity with allowing us to take cuttings and giving us such a wonderful tour of her garden and her amazing bonsai plants.

On the 30<sup>th</sup> of June we will be having our "Pot Luck" Luncheon. We will be starting at noon. All welcome. Hoping, to see you there. Still on the calendar for this year is:

13<sup>th</sup> August – CanAssist Cake Auction

13<sup>th</sup> October – High Tea

20<sup>th</sup> -21<sup>st</sup> of October – Trip to Japanese Gardens at Cowra

1<sup>st</sup> November – Melbourne Cup Luncheon

5<sup>th</sup> November Field Day – Stall

13<sup>th</sup> December – Christmas Party

Happy Gardening , Ros Woods

*Windellama Garden*

*Club Inc*

*Invite you all to attend our*

*"Pot Luck"*

*Luncheon*

*For a 3 Course Meal*

*Where: Windellama Hall*

*Time: Start 12 noon*

*Cost: \$20 per person*

*Date: 30<sup>th</sup> of June*

*RSVP: no later than the 23<sup>rd</sup> June*

*Ros Woods 48445128*



# Countrywide Shower Screens



## Shower Screens

• Frameless • Semi-framed • Framed

## Mirrors

• Bevelled • Polished

**Mick Greenwood**  
**0448 494 220**

Fax: (02) 4849 4220

E: [countrywideshowerscreens@bigpond.com](mailto:countrywideshowerscreens@bigpond.com)

**Free Measure and Quote**

# Lowline Cattle

A small beefy, Angus derived breed – quite & easy to handle.

## Why Lowlines?

### MORE BEEF TO THE HECTARE

- ✓ smaller size means easier handling ✓ higher stocking rates
- ✓ low birth-weights ✓ early maturity ✓ compact bodies
- ✓ excellent feed efficiency ✓ less stress on fencing ✓ less soil compaction



Great for first time cattle owners of any age and gender

## Windellama Downs

*Producing quality, Australian breed cattle & sheep  
suitable for any size rural holding*

## Stock for sale

Commercial or registered stud stock

Mob: 0416 047 488 Ph: 4844 5175

Email: [windellamadowns@iinet.net.au](mailto:windellamadowns@iinet.net.au)

# RON WENBAN

## \*\* LOCAL ELECTRICIAN

\*\*

Rural \* Domestic \* Commercial

**PH: 0428 445 259**

Email: [ronwenban@skymesh.com.au](mailto:ronwenban@skymesh.com.au)

NSW LIC. #174303C

ACT LIC. #2008568



## Southern Districts Piano Service

Pianos • Pianolas • Tuning • Repairs  
Re-polishing • Removals

*Graham Price*

**02 4844 5329**

**Industrial • Commercial • Rural • Domestic**  
**Ph 4844 7088 INSTALLATIONS 0418 234 289**

# ALLARD

**ELECTRICAL CONTRACTING SERVICES**  
**SOLAR UTILITIES & ENERGY SERVICES**  
**GAS-OIL COMBUSTION SERVICES**

[stevenallard@bigpond.com](mailto:stevenallard@bigpond.com)

## ELECTRICAL LICENCES:

NSW Lic.No 198855C

NSW Lic.No 498875S

ACT Lic.No 2009576

QLD Lic.No C13290

## ACCREDITATIONS

AUS C.E.C. Design & Install Grid Connect  
Stand Alone Solar Systems #A3632173

&



# WINDELLAMA VOLUNTEER RURAL FIRE BRIGADE

## WINDELLAMA RURAL FIRE BRIGADE

Report all Fires 000  
& Emergencies

Brigade enquiries 4844 5359  
UHF 21

Yass - 6226 3100



RFS website [www.rfs.nsw.gov.au](http://www.rfs.nsw.gov.au)

or

Brigade website [www.windellamarfs.com.au](http://www.windellamarfs.com.au)

**Captain – Rex Hockey 4844 5147**

**Snr Deputy – Jim Meehan, 4844 5554**

### BUSH FIRE DANGER PERIOD FINISHED ON 31st MARCH 2016

#### SOUTHERN TABLELANDS ZONE

#### **Burning-off now permitted with regulations:**

While the fire season has finished and permits are not required for burning off from the 1st April 2016, there are still regulations that must be followed. Fines can apply if regulations are not carried out. IF YOU'RE NOT SURE CONTACT YASS FIRST.

# Yass MUST be notified 24 hours before you light the fire, during business hours 9am to 5pm and by 3.30pm on Friday afternoons, phone 6226 3100.

# Your immediate neighbours must also be notified.

# Notify the Brigade as a courtesy to save time, if smoke is spotted, phone 4844 5359.

**For more information contact one of the Brigade phone numbers above.**

## A.G.M. JUNE 25<sup>TH</sup> 6PM

### **AGM**

The AGM will be held on Saturday 25th June 2016 at the Fire Station, 6pm, all welcome.

To be eligible to vote or nominate at the AGM members must be registered with the Rural Fire Service for Windellama Brigade and be financial and meet the requirement for that position/nomination. All nominations must be in writing, and returned to the Secretary 7 days prior to the AGM. Nomination forms are available from the Captain, President and Secretary or the Brigade website [www.windellamarfs.com.au](http://www.windellamarfs.com.au).

### **A new online tool for residents**

The NSW RFS has released a tool to help residents assess whether they live on bush fire prone land. Previously residents could only refer to bush fire prone land maps from their local council.

For the first time, residents can check their own address on the NSW RFS website by simply typing their address and hitting 'get results'.

The NSW RFS has a number of valuable tools to help people plan and prepare for bush fires, like the latest Guide to making a bush fire survival plan. A media release about this online tool is available on the NSW RFS website.

For any enquiries about the tool contact the team at [bushfireprone.mapping@rfs.nsw.gov.au](mailto:bushfireprone.mapping@rfs.nsw.gov.au).

**(continued page 15)**

# Nirvalley Homestead NURSERY



629 Cullulla Rd, Tarago

PH **4849 4481**



M 0419 257 663 E. [nirvalley@optusnet.com.au](mailto:nirvalley@optusnet.com.au)

Find us on FACEBOOK



*June*  
**Sale**  
**25% off**  
**natives**  
*plus* **10% off**

## ALL TREES & SHRUBS

All our plants are ideal for local conditions and fully acclimatised

- Big range of natives and shrubs
- Conifers, Hedging, Windbreak
  - Paddock & Feature trees
- Advanced Trees • Tube stock
- Fruit Trees, Nuts & Berries

**Bare root FRUIT TREES & ORNAMENTALS** arriving soon



## TARAGO PRE-SCHOOL

Open 5 days a week

Monday - Friday  
Children 18 months - 6 years

Standard Rate - \$35/day

Casual and Half days available

Subsidised rates on application



We follow the curriculum set out by the

Early Years Learning Framework

Preschools NSW - Education for Life



Ph. 4849 4427

[tarago.preschool@gmail.com](mailto:tarago.preschool@gmail.com)

Our staff are Diploma & Cert III qualified

or

Studying the Cert III in childcare



## A bit of The Muffet Family History:

Disclaimer: The information contained within has been documented from historical records and information 'passed down' from various family members to the best of my recollection.

The family history regarding the Muffet family all started back on the other side of the world, Kent, England to be precise.

In 1828 a teenage lad (16 or 17 years old at the time) he was born in London in 1811 and was arrested, charged, and found guilty by a British Court of 'stealing from a residence'. His punishment for this non-violent, petty theft was LIFE in prison, to be served in the recently acquired British colony on the other side of the Earth, Australia. The name of this unfortunate teenager was Charles Robert Muffet (I), the great, great Grandfather of Kevin and Ronnie Muffet!

One might be tempted to ask...Why send a minor to a penal colony on the other side of the world for a petty crime? The expansion of the British Empire to colonise Australia created a massive demand for a timely, large-scale, manual-labour workforce to start building the needed infrastructure for this new distant colony. Alas, due to the incredible distance, expenses and the potential dangers associated with such a journey, willing labourers were very few and far between. The British government had to look elsewhere for its much needed work-force.

Coincidentally, it was around this time, that the British Courts started handing out LIFE sentences to be served 'in Australia' to both 'adults' and 'minors' for petty crimes such as stealing 'bread' or a 'spool-of-cotton' from a dwelling or shop. Indeed the demand for that labour-force was massive, 185,000 (documented) British convicts (many of them petty criminals) were sentenced to imprisonment in Australia.

Kevin and Ronnie's poor old great, great, grandfather was one of those 185,000 prisoners. Now don't go thinking things like 'child-labour' or 'slave labour', or another 'stolen generation', that's silly, after all we are talking about the British Crown, and I'm guessing that it has a good track record on all these issues, right?



So anyway, in 1828, Charles Robert Muffet (I) departed Kent on a prison-ship bound for Australia never to see his family again. Life as an Australian convict wasn't the most desirable lifestyle of that time. With only basic hand tools, the early convicts had to manually carve out roads, build railway tracks, construct bridges, and not forgetting the initial infrastructure needed to both house and feed all of the Crown's Officers, soldiers, employees, freepersons, and all those prisoners.

But in spite of all the hardships and brutal punishments handed out to the convicts, Charles Robert Muffet (I) survived a decade of imprisonment. Then, 10 years into his LIFE sentence, by an amazing act of mercy, the British Crown reduced his LIFE sentence to just 10 years. Incredible! So sometime during 1838, Charles Robert Muffet (I) became a free man... stranded on the other side of the world. They didn't give him a return ticket.



# *Rusty Balls*

- . Natural bush soaps
- . Pet shampoo
- . Anti-bug balls - natural insect repellent
- . Blind Baking Balls
- . Hand made ceramics

Gary & Denise Johnson

**4844 5087**

**sales@rustyballs.com**

**www.rustyballs.com**

# **SHEPHERD'S HILL NURSERY**

**321 George St, Marulan**

**Ph 4841 1404**

Fax: 4841 1454    Mobile: 0413 047 105

*Look for the house on the hill*

For all your garden needs &  
acclimatised plants

**Potted colour, Seedlings,  
Bulbs, Fruit trees, Ornamental  
trees, Windbreakers,**

**Shrubs and more**

**Potting Mixes & quality soils &  
mulches.**



**A1**

**SEPTIC TANK  
&  
GREASE TRAP  
CLEANING SERVICES**



**0408 483 943**

Bob Baird    Goulburn

**PH: 4822 3290**

7 DAYS—SERVICING ALL AREAS

## **BUSINESS REQUISITES**

### ***Sales & Service***

- . Photo Copiers
- . Fax Machine
- . Cash Registers
- . Computers
- . Stationery
- . Consumables

Ph: **4821 5109**

E: **bus\_req@ozemail.com.au**

**10 Russell Lane, Goulburn**



This is the month to clean up the garden, and start a compost heap. You can use leaves from the trees, lawn clippings, animal manure, shrub and tree pruning. Don't use newspaper, fresh sawdust (old saw dust is okay), eucalyptus leaves or pine tree foliage.

Start the heap by spreading the material to a depth of 20cm. then give a heavy dressing of agricultural lime and complete fertilizer, then cover with a thin layer of topsoil, let the heap build up to a depth of 1m. During the warm weather compost should be ready for use within 10 to 12 weeks, if the compost gets too dry, give it a good watering.

June is the season to plant your new roses. Fruit trees can also go in now, make sure you prepare the soil with old manure and compost before planting.

### VEGETABLES

Sow seeds of broad beans, peas. Onions seedlings can be planted now.

Rhubarb crowns can be planted or divided now. Give them plenty of rotted manure, compost, balanced fertilizer and during the warm weather, plenty of water.

Strawberry plants can be divided now. Pine needles are good ground cover for these plants.

### FLOWERS

Seedlings which are planted now will start flowering in the spring. Stock, Pansy, viola, primula, wallflower, Russell lupins, delphiniums, foxgloves, Iceland poppies, sweet William and calendula.

This month if there are any gardens which aren't being used, turn the soil over regularly roughly to open it up, and the frost will sweeten the soil.

Prune deciduous ornamental and fruit trees after they lose their foliage.

Lift, divide and replant agapanthus, daylily and bearded iris.

Apply a fortnightly foliar feed of liquid fertilizer to potted and garden cyclamen to keep them happy, healthy and full of blooms.

Cut back chrysanthemums when they finish flowering.

Feed emerging bulbs, such as hyacinth, daffodil, tulips with liquid fertilizer.



# WINDELLAMA PLAYGROUP

at

Windellama Public School

Each Thursday

9.30am – 11.30am



**BYO snacks - tea & coffee supplied**

**Qualified art teacher visiting each fortnight**

**Bring your bubs & toddlers for a fun morning**

**Music, stories, sand-play, free-play, art, craft.**

## FREE!



JCF Contractors are the specialist team to ensure your project has the manpower to complete all your key projects on time, to budget and at the highest level of quality.

No matter what your project, JCF can assist you in:

- Earthmoving
- Road Works
- Driveways
- Site Works
- Arenas
- Demolition
- Footings & Piers
- House Excavation
- Shed Sites
- Rubbish Removal
- Septics
- Landscaping
- Trenching

**Call Jon today for your FREE quote**  
**0428 624 966**

Goulburn and surrounding areas





(from page 9)

### **Camp fire is approximately 1 metre square.**

A pile burn should not be greater than 2m in length or width, and must not be greater than 1.5m high. Make the pile wide and long rather than high. This will spread the heat and be safer. Refer to standards for Pile Burning.



### **Over the Last Month**

The Captain Rex Hockey advised that there were three incidents over the last month. **1)** Windellama Road when a grass burn-off had escaped. **2)** A prescribed burn-off caused concerns at Minshull Road. **A 3)** large bonfire at Lumley Road without authorisation.

### **Training**

If you wish to take part in the Windellama Brigade training or be contacted by email regarding the monthly training details visit the Brigades website and send an online contact form or email [windellamarfstraining@gmail.com](mailto:windellamarfstraining@gmail.com). For information on training dates, times and scenarios check the Brigade website or contact the Captain Rex Hockey 4844 5147

[www.windellamarfs.com.au](http://www.windellamarfs.com.au)

**AGM** 25th June – 6pm

**Training** -25th June – 1pm

**General Meeting** 23rd July – 6pm

**Training** -23rd July – 1pm

Please take care on our roads and see you at the next training and meeting. All welcome.

## **Windellama SES First Aid & CFR**

We are well into training for the year, members choosing to take courses to which they are suited, after the compulsory requirements have been completed. SES training is recognized as being of a very high standard, conforming to the requirement of the relevant authorities. I personally witnessed as to why, it is advisable to undertake a recognized tree felling course, there are several authorities who undertake these activities.

Our members were saddened to hear of the Death of one of our dear friends on the 12th of May. He was one Len Ryan, late of Adanac Minshull Road Windellama. He died in Dubbo. He and his wife June lived at Coonabarrabran. I shall inform people of his exploits relating to relevant activities as far as the history of our First Aid Services, in next month's issue.

Kevin Muffet Deputy Unit Controller Windellama SES/CFR

# ACOM DESIGN

PO Box 806,  
Goulburn 2580

Yarralla,  
Oallen Ford Rd  
Bungonia 2580

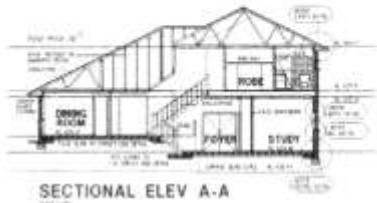

**Robert C Everingham**

*Building Designer & Draftsman*

**New Homes, Alterations & Additions**  
Duplex, Villa, Townhouse Developments  
Rural, Commercial, Industrial Buildings  
Free Quotes - Competitive Rates - Prompt Service  
Energy Efficient (SEDA), Eng Dwgs: Mech, Struct, HVAC

**TEL 4844 4321**

**MOBILE 0417 682 022**

**FAX 4844 4323**

**EMAIL [acomdesign@bigpond.com.au](mailto:acomdesign@bigpond.com.au)**



MEMBER  
STANDARDS AUSTRALIA



MEMBER  
BUILDING  
DESIGNERS  
ASSOCIATION  
OF NEW SOUTH WALES INCORP

## Heard of Wiltipoll Sheep?

The Wiltipoll is a hardy, prime lamb, wool shedding breed developed in Australia



- ✓ Full wool shedding – no costs of shearing
- ✓ Fly lice & grass seed resistant
- ✓ No jetting dipping or mulesing
- ✓ Stays in allocated paddock
- ✓ Superior quality meat sheep
- ✓ Ideal for organic lamb production - consistent multiple births

### Windellama Downs



#### **Stock for Sale**

Commercial or Registered Stud Stock

Mob: 0416 047 488 Ph: 4844 5175

Email: [windellamadowns@inet.net.au](mailto:windellamadowns@inet.net.au)

**This Space is available for  
your advertisement  
\$16 per month**

## yarralaw springs wines

Goulburn & Southern Tablelands Newest Winery

Cellar Door Upcoming Open Days

Hours – 11am to 4:00 pm

Sunday: 5 June

Sunday: 12 June

Sunday: 19 June

~check website for any changes or

call prior for a drop in visit or purchase anytime ~  
25 kms down Windellama Road from Goulburn  
turn left into Muffets Road

email: [admin@yarralawsprings.com.au](mailto:admin@yarralawsprings.com.au)

web: [www.yarralawsprings.com.au](http://www.yarralawsprings.com.au)



## WILLOWGLEN GARDEN CLUBBERS – May Meeting

Olive harvesting day with Liz-Ann & Peter at Dreamers Edge dawned fine, sunny & calm - no westerly winds like yesterday (but we were in for a nasty surprise just a few hours later). We started with members & their gardens. Ron & Thoreen have been growing feasts of heritage vegetables – yellow & green beetroot, purple carrots, eggplants & tomatoes but unfortunately wallabies have eaten all the blooms on their roses, 40-50 plants! They are also experiencing lots of annoying chuffs (red eyes) pulling out small plants & sending the compost pile flying everywhere.

Ni & Alan also have problems with wallabies eating their plants, but their new polytunnel is going great – for cuttings & drying out firewood so far, lots more use planned for later.



Jackie & Doug's capsicums & tomatoes are still growing & producing and their irises & roses are beautiful (they've been watered). Jackie has now seen rabbits burrowing under the shadehouse where her veggies are growing but just the other day she watched a big eagle fly up, swoop down & then fly back up again with a snake in its beak – a warning to us all that despite the recent cold weather, snakes are still about. Shirley said her garden

You expect me to reach them how?

is going back to nature, and the bulbs she gave us last month are starting to sprout at Dreamers Edge, so we're all anxious to see what they are. Katie picked her kiwifruit as advised & has been waiting over 2 weeks for them to ripen with no luck – others thought apples in with them might help ripen them. Her tomatoes have been rotten underneath – it could be a virus (you need to rotate beds each time you plant), or too much moisture, or their bottoms are too close to the ground (oh to have a photo of that).



Wow this tree is loaded

Irene has made green tomato pickles and had lots of small capsicums. She planted a new bed of broadbeans & they're still eating last season's crop from the freezer. The sheep loved all the apples they fed them from their tree. Lloyd brought some the persimmons from his tree that still need to ripen but at least he beat the birds to them. They were disappointed about the lack of turnout to Landcare on the weekend – as a result the work at Chain o' Ponds couldn't go ahead but they had plenty of sandwiches left to consume. Irene will be making delicious quince jam soon – Sandra & Tony couldn't be with us but we had brought back plenty of bags of quinces from their trees for members to make quince jam, jelly or paste. There were other takers as well so you might even smell it cooking around the neighbourhood.

Now to the olive harvest. Not many olives on the tree this year because we've left it later than usual to harvest, so that our fellow Garden Clubbers could have a different experience to the usual beautiful gardens. The olives we did get this year are almost overripe, more strewn on the ground under the trees than on the trees. Next year we need to go back to harvesting

*(Continued on page 19)*



# Better Barbeques



At Barbeques Galore you'll discover a whole new world of outdoor entertaining.

A lot of places are selling outdoor products, like Barbeques. The difference is WE can show you how to use them!

We've got a huge range of the latest aluminium, wicker and timber settings to suit both the size and style of your backyard.

**4821 1292 or 4821 4889**

388 Auburn Street, Goulburn [www.barbaquasgalora.com.au](http://www.barbaquasgalora.com.au)

**LARGE RANGE  
GREAT PRICES  
FRIENDLY STAFF  
GREAT SERVICE**

**BARBEQUES  
GALORE**

**BBQBaHar.**

(Continued from page 17)

before Anzac Day as we used to do – then we should miss early frosts & bird strike on ripe olives and at least end up with a worthwhile crop of olives (this year's harvest was only about 10kg, much the same as last year's). A short time harvesting was followed by the traditional sausage sizzle under our carport sheltered from the west. We gave up battling to keep tablecloths on tables with the gale force winds last year, so this year we didn't bother about tablecloths just in case. Would you believe it, gale force winds struck again, but changing direction just to attack us – glasses, plates & people flying through the air all around us, oops.



Katie & Ni chatting and picking

Thank you to everyone who came to help harvest, hopefully you enjoyed the day and it wasn't too onerous a task – it was great to see you all.

Our next meeting will be Tuesday 7th June at the Engisch's, just up the road from Dreamers Edge. As always, everybody is welcome (please bring a plate for morning tea).

Liz-Ann

## Update on Windellama Landcare; The Green Army

Hello Everyone!

Landcare were fortunate enough to be able to get the services of the Federal Government's Green Army activity in January to clear weeds on Strawberry Creek Rd. Strawberry Creek Rd is a Crown road and therefore the council accepts no responsibility.



The Green Army were requested to clear a section of serrated tussock and an infestation of blackberry where the road crosses Bogungra Creek. On the 27th January a Green Army crew of eight people, mainly TAFE students, removed by chipping the serrated tussock along a 300 metre section of the road (one of our members assisted by removing the seeds before chipping).

Unfortunately, the work crew was unable to attend as scheduled on the 28th to deal with the Blackberries because the crew had a clash with TAFE work before graduation the following week. However, Landcare has asked for this work to be done early in the next round of Green Army work.

Landcare has also requested a follow-up by the Green Army activity in the spring, hopefully October if it can be arranged, to deal with any regrowth.

Landcare is interested in any work areas where we may be able to request Green Army assistance so if readers know any infestations of weeds please contact John Pearce (0248445244) with the details (type of weeds, location (property, road, etc), size and co-ordinates (if available).

From the pen of Henry Detjen,  
Treasurer Windellama Landcare

Windellama Landcare is always looking for new projects, so if you've got something in mind (or are interested in finding out exactly what we do) please don't hesitate to contact us.

Kind Regards,

*Jade Kinder*

Secretary Windellama Landcare



# FOR ALL YOUR EXCAVATING AND EARTHMOVING NEEDS THINK **DIVALL'S**



**Divall's has the experience, expertise and an expansive fleet of truck and machinery to get the job done.**

**FOR EXPERT ADVICE CALL (02) 4829 8200**

- Quarries
- Earthmoving
- Crushing
- Dams
- Subdivisions
- Demolition
- Bulk Haulage
- Civil Works
- Sand & Soil etc
- Road Base
- Sealing
- Clearing
- Erosion Control

## **PLANT HIRE**

- Dozer
- Rollers
- Mini Excavators
- Excavators
- Scrapers
- Backhoes
- Loaders
- Crusher
- Graders
- Bobcats
- Loaders
- Screens

## **TRUCK HIRE**

- Tippers
- Floats
- Tilt Tray
- Water Cart



**282 CARRICK ROAD, GOULBURN NSW 2580**

**PHONE: (02) 4829 8200**

**WEBSITE: WWW.DIVALLS.COM.AU**





NSW Wildlife Information,  
Rescue & Education Service Inc.  
**SOUTHERN TABLELANDS  
BRANCH**



## ROSIE'S NOSE JOB!

By Kay Muddiman – Media Officer

Rosie was a wombat – the only wombat in the Southern Tablelands to have had a nose job! Now Rosie was not unhappy with her nose – it was a very nice wombat nose. The only trouble was it developed a lump after she took a tiny bit of skin off trying to escape the carry cage when she first came into care as a small joey, weighing in at 1600g. Neither we nor our wonderful vet at Crookwell Veterinary Hospital were unduly concerned at first, expecting it to settle after a while – however, when it didn't we went back to the vet pronto. First diagnosis was fluid, but a needle inserted into it produced nothing but a bit of blood. It was then thought maybe it was fibrous tissue, which unless it increased in size would not cause her any problem. So, the advice was to 'wait and see'. The lump didn't appear to be growing at first, but



then all of a sudden it started increasing in size – plus she started developing a couple more lumps along the top of her nose. Alarm bells sounded, and on the advice of our vet we arranged a consultation with the University of Sydney's Avian, Reptile & Exotic Pet Hospital at Camden, where they specialise in our native wildlife.

First of all they did a hollow needle biopsy - poor girl, it was so painful for her - she made the most dreadful noise while they were doing it, I could have cried for her. When tested this showed an infection, so they then put her under anaesthetic to do a full biopsy for culture, to determine exactly what type of infection. While doing the biopsy the vet discovered an abscess really deep down. We were stunned as there was no redness or anything else to indicate an abscess, and Rosie never ever showed any sign of distress with the lump, even when pressure was applied to it. The vet said that as he cut in for the biopsy, much to his amazement all this yuck and stuff poured out! So, she came home on Baytril by injection for 14 days, and we had to keep the wound open for as long as possible by irrigating it with saline solution a couple of times a day, so it could heal from the inside out. She did NOT like that being done, and I don't blame her! Needless to say she didn't like the injections either!

We got the results of the culture four days later, which showed a Staph infection. I was horrified as I always take great care with hygiene. However the vet at Camden said it was nothing to do with that, they can carry the bacteria on their skin without any effect, it's just when it can get 'in' that you have a problem. The good news was that Baytril was right for it, so we didn't have to start a fresh round of 14 injections of any other med. By the time she had finished the injections the wound was healing well, and she was more full of beans than ever! From then on Rosie thrived, with nothing but a small scar to show for her nose job! After a further ten months rehabilitation she was able to be released back into the wild to embrace her freedom.

What did I learn from all this? A lot. Such as how difficult it is to give a wombat an 'under skin' injection – they are such a ball of muscle and just don't have any loose skin to grab hold of! It is definitely a two person job. Also, it is important to investigate any problem thoroughly, as things are not always what they seem. An accurate diagnosis is essential before any medication is administered, to ensure correct treatment. I learned not to 'wait and see' for too long. I learned how wonderful the folk are at Camden – thorough, caring and compassionate. I also learned how loving and forgiving Rosie was – no matter what we had to put her through, she always forgave us and was ready for a play and a cuddle. She was quite simply, a sweetheart.

***Should you need advice or help with injured or distressed wildlife, please ring our Branch Rescue Number – 4822 3888. Our volunteers will be only too happy to assist.***

Until next time – take care all.

Kay

*Top left: Rosie's lump – you can just see a small one starting next to it.*

*Top right: Rosie's poor nose following surgery.*

*Bottom: A few months on – thriving and well on her way to release*

WINDELLAMA HALL COUNTRY MARKETS

*Sunday 19th June*

*9am to 1pm*

*Homemade Jams & Preserves*

*Pre loved toys/tools*

*Locally produced honey*

*Lots for the sewing enthusiast*

*Bric-a-Brac*

*Variety of plants*

*Gourmet foods*

*Wooden Nick Nacks & Toys*

*Rawleigh Healthcare*

Food and refreshments

New stallholders welcome

Enquiries *Grahame Woodcock*

48447275

Plenty of parking

Museum open

# Windellama Public School News

**Email:** [windellama-p.school@det.nsw.edu.au](mailto:windellama-p.school@det.nsw.edu.au)

**Phone:** 4844 5130

**Website:** [www.windellama-p.schools.nsw.edu.au](http://www.windellama-p.schools.nsw.edu.au)

**Fax:** 4844 5265

## DISTRICT CROSS COUNTRY & REGIONAL ATHLETICS

Congratulations to students who have made it to Regional Athletics and District Cross Country. We wish you well and hope you enjoy the experience.

## ATHLETICS COACHING

A BIG thank you to our local athletics coach Marina Wenban who has volunteered to coach our relay team before they go to Regional Athletics in Term 3. The students really enjoy their training sessions with Marina.

## JUMP ROPE FOR HEART

Recently we participated in Jump Rope for Heart. Students enjoyed the activities and physical exercise whilst raising awareness and money for the Heart Foundation.



## ANNUAL P&C FIREWORKS AND AUCTION NIGHT

The P&C annual fireworks are on again this June long weekend (Saturday 11) at 2.00pm. This is the major fundraiser for the P&C and many long hours go into preparing for the occasion.

It is a great community event with show bags, glow products, face painting, pick-a-jar, gum boot throwing competition and entertainment for the kids. You'll find delicious food and lots of great items in the auction. On dusk the fireworks will begin and there will be a bonfire to keep everyone warm. Please come along and support our P&C by joining in to help a worthy cause.

## TENNIS LESSONS

Students have begun a 6 week coaching program with tennis coach Dave Ridland.

## PLAYGROUP

The Windellama Playgroup meets every Thursday between 9.30 – 11.30. It's a great opportunity for pre-schoolers and parents to get together with one another in our wonderful little school.





## MICK'S MULTI TRADES

ABN: 90 178 544 738

Multi Skilled Tradesman

Windellama NSW

Lic # MVTC 126573

Mob: 0413 059 587

Email: [micksmultitrades@gmail.com](mailto:micksmultitrades@gmail.com)

Proudly supporting the Windellama community is Mick

A multi skilled tradesman and diesel mechanic by trade

We renovate bathrooms, tiling and floating floors.

We can also build your shed and help you design and convert your shed into a home, installing your water tanks and fencing.

I have always looked after the locals, and turn a hand to any job.

**So shoot me an email or phone anytime, you'll be pleasantly surprised at our down to earth rates.**



# CJ Solar

"Quality Systems that last"



**Home, Business or Community Organisations**

**Custom Designed To Meet Your Energy Needs**

- ◆ Stand Alone Systems
- ◆ OnGrid With Battery Backup
- ◆ Grid Connect
- ◆ Clean Energy Council Accredited

**Ph: 4849 4225**

**[www.cjsolar.com.au](http://www.cjsolar.com.au)**

PREVIOUSLY TRADING AS SUN POWER

LICENSED ELECTRICAL CONTRACTORS (241654C)

## RFS Hotspots Project Workshop –

The first two-part RFS Hotspots Project Workshop was held at Nerriga Hall on April 30 and May 14. Organised by the NSW Rural Fire Service in collaboration with the Nature Conservation Council, the Hotspots Fire Project “enables landholders and public land managers to work together to reduce bush fire risk across the landscape, whilst maintaining and improving biodiversity”.



The first day was mostly at Nerriga Hall, with a visit to the chosen fire site just prior to lunch. The second day also started at the Hall, with a recap and morning tea; then everyone ventured out to the fire site on Old Timberlight Road accompanied by the local Nerriga RFS trucks and equipment. Lunch and afternoon tea were served there. Fortunately, the wind was absent for that day. Nerriga Progress Association catered for both days, and thanks to all the volunteers who helped. Due to popular demand, there will be another Hotspots Workshop which is scheduled for July 30 and August 20. Check out their website [www.hotspotsfireproject.org.au](http://www.hotspotsfireproject.org.au). Workshop enquiries Phil Paterson – Email: [phil.paterson@rfs.nsw.gov.au](mailto:phil.paterson@rfs.nsw.gov.au).

NPSA enquiries – Email: [helenrolland@bigpond.com](mailto:helenrolland@bigpond.com).



NPSA is holding their first Cake Stall and Sausage Sizzle at Nerriga Hall on Saturday June 11 - Queens Birthday Long Weekend. Hope to see you there.

## NERRIGA HALL

fees for Hire of Hall and Supper Room

Hall

Full Day \$220

Half Day \$110

Supper Room \$66

Kitchen \$110

*All fees inclusive of GST*

*Security/Cleaning Fee \$100*

*Refundable on Inspection*

**To book please contact**

Helen Rolland 02 4845 9115

[helenrolland@bigpond.com](mailto:helenrolland@bigpond.com)

# P R O N I C

A G R I

A mobile service for all your rural living  
mechanical repairs

Service & repair of : -

Tractors  
Self propelled machinery  
Sprayers  
Quad bikes  
Air conditioning  
Ride on mowers  
And all general farm machinery

Contact Mathew Nicholls

Tel : 02 4844 5857 Mob 0417 998 938

e-mail : [proniacagri@yahoo.com](mailto:proniacagri@yahoo.com)

abn 28 228 073 983

a/c licence no: L058811

## Booyong Alpacas

2217 Windellama Rd.

Quialigo. NSW. 2580.

Tel.02 4844 7267.

Mob. 0417 658730.

Web. [www.booyong.com.au](http://www.booyong.com.au)

Like us on Facebook

[www.facebook.com/booyongalpacashop](http://www.facebook.com/booyongalpacashop)

Email: [booyongalpacas@optusnet.com.au](mailto:booyongalpacas@optusnet.com.au)



**Breeding Coloured Huacaya Alpacas**

since 1997 with a current herd of 175 Alpacas

**Alpaca Sales & Stud Services**

**On Farm Alpaca Shop**

selling 100% Booyong Alpaca Products  
& Selected Imported Alpaca Garments.

Call us for advice or to visit the farm & view  
our Alpacas & Shop.

Buying or selling house or land?

## JOHNSON & SENDALL

Incorporating Mullens & Stephen J Lamond

SOLICITORS – CONVEYANCERS

For advice on all your legal requirements

Morris Owen ~ Alison Howarth ~ Tim McGrath ~ Carl Henwood

p: 02 4821 1588 f: 02 4821 9850 e: [info@johnsonandsendall.com.au](mailto:info@johnsonandsendall.com.au)

[www.johnsonandsendall.com.au](http://www.johnsonandsendall.com.au)

13 Montague Street Goulburn 2580



Athletics Coach  
Personal Trainer  
Marina Wenban

Ph: 0439 029 313

Accredited Athletics Australia,

AT&FCA, Fitness Australia



**General Plumbing  
Maintenance and roofing  
Drainage  
Gas-LPG**

**Renovation work  
TMV & Backflow prevention**

**ABN 56756688933**

**Licence 2009704**

**Jason Tolar  
Mobile 0418227480  
[evp.plumbing@gmail.com](mailto:evp.plumbing@gmail.com)**



## Nerriga Garden Club

Today Wednesday 18th of May we went to visit Lynley and Gary's block near Nerriga which was a lovely drive through tall trees along a winding dirt road with the gate marked by a large sunflower. They are in the process of building a very interesting house which will nestle into the hillside and looks north. They have no mains power but do have ADSL broadband!!!! The wonders of major utilities. Depending on your outlook or mood or the weather, they have a lovely treed block with almost no level ground so it is either a massive blank canvas for ideas or a challenge. They have risen to the challenge and are planting lots of interesting trees which the wallabies are really enjoying. They have got macadamias, olives, a native frangipani and others that I look at with envy as I have tried same but they all succumbed to the frost whereas under the tree canopy and being elevated the frost rolls away!

Lynley has a lovely elevated courtyard which is supporting lots of pots and elevated beds of vegetables and this is the one wallaby free zone as they have even got around the fence at the top of the excavation and munch along the narrow ledge beside it. There are plans for an orchard and along the gully they are planting fire retardant trees and with time hope to extend the plantings up the drier slopes. Also the septic will eventually feed into a reed bed and then the filtered water will be available for trees. The whole set up is quite daunting to a non builder but very impressive and we will return in a year or so to see the progress.

Next meeting on Wednesday 16th of June we have been invited to Di Roberts new abode in Nowra to workshop ideas and see how her pots are settling in. We will meet at 9am at Nerriga Hall to car pool for the drive to Nowra.

Happy gardening

## MANY HUME VOTERS WILL BE VOTING EARLY

With many Hume voters expected to vote before polling day on July 2, Federal Member for Hume Angus Taylor has advised that residents can apply to lodge a postal vote through Australia Post.

Residents will have received in recent days a letter in the post inviting them to apply for a Postal Vote Application pack.

"If you are unable to get to a polling booth to vote on Election Day, a postal vote is perfectly acceptable. You can also vote at local prepoll centres, which will be set up in the weeks before Election Day at several locations in Hume," Mr Taylor said.

At the 2013 Federal election 1,343 Hume residents voted via postal vote and more than 1.3 million postal vote applications were received nationally.

The Australian Electoral Commission will shortly be mailing voting packages to voters who have applied for a postal vote.

"There are many reasons why someone may need to submit a postal vote - if you know you will be outside the electorate on polling day, if you are travelling, or if you are seriously ill.

"Because more and more people are voting early, I encourage people to get organised if they know already that they will not be here on July 2."

You can apply for a postal vote online at [www.aec.gov.au](http://www.aec.gov.au). The AEC must receive your application by 6pm on the Wednesday before polling day for your application to be accepted.

Return your completed application as soon as possible and ensure you leave enough time for your vote to be completed by polling day and returned to the AEC.

For more details on postal vote eligibility, visit the AEC website at [www.aec.gov.au](http://www.aec.gov.au).

# **WANTED**

**Rural Properties  
To Sell – Large or Small**

**Over 25 Years experience**

**Call Allan, Tony or Greg**

**on 4822 1411**

**LARGE REWARDS**



**Professionals**

**Goulburn**

His circumstance might have caused him to think thoughts of depression and injustice, not so, within a year of his release, Charles Muffet (I) married Louisa Green at Goulburn, NSW on June 5, 1839. They acquired a property at Windellama NSW called 'Rose Vale'. Dear Charles and Louisa didn't muck around out there, they registered the birth of 14 children while living at Rose Vale, now here's proof of what can happen if you take a 17 year old lad and lock him in prison for 10 years.

Not only did they love having lots of children themselves, but old Charles was also burdened for all the other children being raised in the Windellama district as well. There was no nearby school for educating them, so Charles and Louisa took it upon themselves to build a combined School House and Church for the Windellama district. Charles no doubt was fully aware of the circumstances that put him on the wrong side of the law for stealing; an impoverished, unemployed youth trying to survive a most difficult period in England's past. He well understood that education was the key out of poverty and unemployment. In appreciation of these contributions by Charles & Louisa for the district, Muffet's Road, Windellama NSW was named after them. You can Google that.

Of those 14 children Charles and Louisa had, the fourth was Charles Robert Muffet (II). Charles Robert Muffet (II) married Mary Matilda Reader and they had 10 children. So Charles Robert Muffet (II) was Kevin and Ronnie's great Grandfather.

Now just to make things a little different, Charles (II) and Mary christened their first born, a son, and you guessed it, Charles Robert Muffet (III). That was Kevin and Ronnie's Grandfather.

Now things get pretty exciting here, you won't believe this, but Charles (Bob) Robert Muffet (III) married Charlotte Louise Croker and they also had 10 children. Sure did! Buba #6 was Stewart Wallace Muffet, so have you figured it out yet...that's right, Stewart was Kevin and Ronnie's dad!

Stewart Wallace Muffet married Freda Ethel Mahoney and they had 3 children, Kevin Wallace Muffet, Ronald (Ron or Ronnie) James Muffet, and dear little June Ethel Muffet who only lived 11 days.

Ronnie was born October 30, 1937. His family lived and worked on a grand property called Brewon, near Goulburn. Stewart & Freda decided to move to the 'Big Smoke' Goulburn NSW when Ronnie was in 5th grade. They purchased a property at 31 Kinghorn Street where they lived out the rest of their lives, Stewart passing November 4, 1976, and then Freda passing in the early 1990's.

After Ronnie had finished his schooling at Goulburn High, he took on a motor mechanic's apprenticeship at Repco Engine Rebuilding Goulburn. After he completed his apprenticeship, he remained at Repco where he was promoted to workshop foreman. It was during this time that Ronnie married Kay Frances Allen at Bowral, April 8, 1961. Ronald James Muffet and Kay Frances Allen had 4 superstar kids: Lovable Leanne, Amiable Anthony, Choral Cathy and Effervescent Emma.

**Researched and written by Anthony Clifton Muffet (Ronnie's son), December 4, 2014.**





The Lieder Theatre Company  
PRESENTS

# PIPPIN

## THE MUSICAL

BOOK BY  
**ROGER O.  
HIRSON**

MUSIC AND LYRICS BY  
**STEPHEN  
SCHWARTZ**



Musical Director  
**MARIANNE POWLES**

Director/Designer  
**CHRISJOHN HANCOCK**

OPENING FRIDAY  
8th July at 7:30pm

Then WEDNESDAY  
20th July at 7:30pm

FRIDAYS  
15th & 22nd July at 7:30pm

SATURDAYS  
16th & 23rd July at 7:30pm

MATINEE  
Saturday 16th July at 2pm

ORIGINALLY PRODUCED ON THE BROADWAY STAGE BY STUART OSTROW  
DIRECTED ON THE BROADWAY STAGE BY BOB FOSSE  
THE ENDING ORIGINALLY CONCEIVED IN 1968 BY MITCH SEBASTIAN  
LICENCED EXCLUSIVELY BY MUSIC THEATRE INTERNATIONAL  
(AUSTRALASIA).  
ALL PERFORMANCE MATERIALS SUPPLIED BY HAL LEONARD AUSTRALIA

**Tickets: [www.liedertheatre.com](http://www.liedertheatre.com)**  
or in person at Goulburn Medical Clinic, McKell Pl, Goulburn

**Enquiries 4821 5066**



Hello Everyone,

Our last market day was just great thanks to the new visitors and a very interesting visit from a Roberts' descendant who really enjoyed the visit to Windellama.

We have our first Bunnings BBQ on 11th June, this is a BIG fund raiser for our museum and its fun!! So come and say hello and enjoy a sausage sizzle.

We are still working on our main endeavor which is to completion of the shed at the back of the museum so we can display our old farming equipment to its full glory.

We do have a few excursions in mind, we apologies to you for not having dates organized. I think we will get winter out of the road before we enjoy our next excursion.

We have Windellama History preserved in our wonderful museum, with lots to look at and lots to talk about, so come and visit on the next market day.

The museum is open on **Market Days** - every third Sunday of each month, from 9ish-am till 1ish-pm and by arrangement.

The Next Meeting will be on Saturday 4th June 2016 10am

**NEW MEMBERS and GUESTS ARE ALWAYS WELCOME**

**For any enquiries please contact: Rex Hockey: 48 445147**

**Marcia Tatam: 48 216421**

**Julian Woods: 48 44 5270**

## Changes to Waste Management Centre Opening Hours

Changes to Waste Management Centre opening hours. From Monday 2 May 2016 Goulburn Mulwaree Council's Waste Centres will operate different hours.

**Goulburn** Waste Management Centre open 7 days per week from 8am to 4pm.

**Marulan** Waste Management Centre to be open from 8am to 4pm on Saturday and Sunday, plus 8am to 12noon on Friday and Monday.

**Tarago** Waste Management Centre to be open from 8am to 4pm on Saturday, Sunday and Monday.

**All Waste Management Centres** will be closed on public holidays and from 12 noon on Christmas Eve.

Marulan and Tarago Waste Management Centres will also be closed from 12noon to 12.30pm on opening days to enable the operator a dedicated lunch break.

# CHURCH INFO

## Catholic Church Services

Parish Priest: Fr. Dermot McDermott

Assistant: Fr. Assin

Deacon: Chris Van Gessel

Presbytery & Parish Office  
Phone 4821 1022

\*\*\*\*\*

Sunday Mass will be at 8am on the 2nd & 4th  
Sunday at St. Patrick's **Marulan**.

Mass Times in **Goulburn** are:

Saturday Vigil Mass:

6pm (DST) at St. Peter & St. Paul's  
Sunday: 7am. at Our Lady of Fatima,  
Nth. Goulburn

Sunday: 10am. at St. Peter & St. Paul's

---

### **St. Joseph's Church, Tarago**

Enquiries: 4821 1022



## **CHURCH SERVICES**

### **St Bartholomew's Windellama**

All Services now at St. Barts

12th June

26th June

Services now start at 10.30 am

Reverend Peter Bertram

---

## **Fees for Hire of Hall or Supper Room at Windellama Hall**

<b>*HALL ALL DAY</b>	<b>\$200</b>
<b>DAY 4hrs or less</b>	<b>\$100</b>
<b>EVENING/NIGHT**</b>	<b>\$200</b>

\*Includes Supper Room & Kitchen

\*\* \$2 per hour for heating

### **SUPPER ROOM (Includes Kitchen)**

<b>ALL DAY</b>	<b>\$80</b>
<b>DAY 4hrs or less</b>	<b>\$40</b>
<b>EVENING/ NIGHT</b>	<b>\$100</b>

# Use of the premises prior to your booked  
function will incur a surcharge of  
Supper Room Fee

**To Book please ring W. P. A. Secretary,  
Christine Woodcock on 4844 7275**

---

### **St. Andrews (Anglican) - Tarago**

2nd Sunday 9am

St. John's - Lake Bathurst

4th Sunday 9am

---

## **NERRIGA**

### **ANGLICAN CHURCH SERVICES**

**Held at Nerriga Church**

**2nd Sunday each month at 2pm**

**(Except Easter & Christmas)**

**All Welcome**



# Classified Advertisements

**All personal classifieds are FREE & also included in the Tarago Times**  
**We run your advert until you let us know when you have sold it or gained it**

## GENERAL FOR SALE

**Sony Bravia HD 42" TV** \$180 ono Ph 48445156

**Teak entertainment unit**, with two glass door display. 6x4 foot. \$75.00 ONO.

**Double bunks**, Metal, with ladder, new innerspring mattresses. \$125 ONO

**Two wooden bed side tables** with cane draws. \$50 for two. Ph. 4849 4480

1 x **King Single bed** \$200; 1 x **Single bed** \$150; 1 x **Single bed** \$100; **Dressing table/ chest of drawers** (8) \$150; 1 x **Glass TV table** \$150; 1 x **Glass coffee table** \$50 Ph 0411 421 416

**Lounges** - 1x3, 1x2 + ottoman - yellow fabric, Matching chair in navy blue. All GC. Offers over \$500 considered. 4849 4222

**Desk** - large timber, 2x draws/storage under. Leather inlay + matching 2 drawers file cab. Ergo office chair. All VGC. \$400 ONO 4849 4222

**Firewood.** \$150 per load. Ph 4849 4520 for delivery

**Firewood.** 2 tonne truck load \$430, ½ truck load \$250. Ph 0401 241 646

**Firewood** - Split, seasoned. Ute load - approx. one tonne. Local delivery - \$150 per load. Ring Greg - 4844 5157.

**999 Oalen Road property 100 Acres** - Land is cleared, suitable for motor bike riding, leisure walking, plenty of firewood to be had, one bedroom house, carpet needs replacing, onsite shed for extra accommodation, 4 x 5,000 gallons tanks drinking water, 1x 5,000 gallons for amenities, ducks and chooks water, 2x big steel sheds with 3 bays each, 1x big/tall hay shed with 3 bays, 30 olive trees, apple x 2, apricot x 2, nectarine x 2, Pear x 2 and plums x 2 trees, securely fenced Chooks and ducks sheds, drive way is circular. 1x carport. 4 x 80, 6 x 85 6x 150 watt Solar power accommodating electric appliances, fridge, Freezer, air conditioner, 8Kva generator included, phone is available. Gas Hot water system Price: \$420,000 ONO. Pls ring 48459147, Genuine enquirer only pls. N Gates

## ANIMAL RELATED FOR SALE

**Parrot Cage** on stand, good cond. \$150 ONO. Ph 0429 006 745

**Saddles**, good condition, \$350 & \$200. ONO. Riding helmets \$30 and \$20. Also other gear: bridles, leather straps, etc. Ph 0434 286311.

**Miniature Shetland Gig** well balanced, hardly used, some harness, pneumatic tyres, lightweight \$730 ono Ph 62301774 or 0417749064

## ANIMALS FOR SALE

**Backyard layers** - FREE. Red Hybrid 21 months, still laying lovely eggs, free-rangers. Only to good homes please. Max up to 5 hens. Email: wochick68@gmail.com

**Piglets** - different ages so different prices. Ph Bob McDonald 0429 494 331

**Alpacas** - lots of different colours & ages. From \$250 each Phone Jacki 0428 298 157

**Quarriors** (cockatiels) - \$8 each Ph 4845 9147 after 6pm

**Horse part Arabian**, 3 yrs old, regd, 14.2 hh, chestnut mare. \$3,000 Ph 0429 461 490

**Alpaca Wethers** Variety of Colours, ages 12 months – 3 years. Halter Trained Wethered, Needled & Shorn. \$400.00 each. Phone 4844 7267. Faye & Keith. Quialigo.

**15 milking goats.** A mixture of male and female. Friendly and well behaved. Price negotiable depending on number purchased. Ring Julia 42761489.

**One six month old pig** for sale - approx. cost \$150. Please call Julia on 4276 1489

## AGISTMENT

**Horse Agistment** available at 41 Burrabinga Road Tarago. Please phone 0429 461 490 for enquires

## CARS, BIKES, TRAILERS, etc. FOR SALE

**Motorhome** Hino Rainbow bus, professionally converted for two. Fully equipped and registered. Inspection welcome. Phone Bruce 0428480650.

**Camper Trailer** Queen sized bed with large room. Plenty storage room. Comes with zipon canopy/shelter. Easy to erect/store/transport. \$3500 ono Ph 62301774 or 0417749064

## Classified Advertisements cont

### RURAL RELATED FOR SALE

**Lucerne Hay** Prime soft green small bales \$15  
8 x 3 x 3 bales of lucerne or beardless wheaten  
available phone 0428493194

**Daken 4'6" Slasher** - \$800 ono 4844 7188

**Berends 10 disc cultivator** 3 point linkage  
\$500 **Daken rondini spreader** SPT 500 3 point  
linkage \$600 Phone 48445369

**Stanbury Electrical 75 amp battery charger** -  
new condition, used twice only for Solar batteries  
- \$1200. Pho 48459147 after 6P.M.

**Gallagher Lightning Diverter** for electric fence  
energiser protection. New & unused - \$30 plus  
**Electranet moveable electric mesh fencing**  
'Masternet' 1.2 x 50m open mesh roll & inbuilt  
semi-rigid fence posts with stepped double pin  
spikes - \$200 each. 2 available. **Fence Energiser**  
**-Solar Thunderbird S65B with battery-** up to  
7.5 km. Panel, energiser & battery, wall charger  
**\$300** Ph: 4844 5843

### WANTED

**Knitting wool** for volunteer knitters for charity.  
Any leftover wool, any ply, gratefully accepted. Ph  
Denise 4844 5087

**Instantaneous LPG** Gas Hot Water system 16-  
20 litres per minute flow rate, working or not. Ph  
Gary or Sharon on 4844 5980

**Licenced/responsible shooter(s)** to cull vermin  
on 2 x 100 acre properties - I have the permits &  
ear tage. Pls phone after 6P.M. 48459147.

## TARAGO TRANSFER & DRUM MUSTER STATION

Open Friday to Monday 8.00am - 4.45pm

Card required for household waste, or fees apply.

Free recycling of: Plastics, tins, batteries, glass, paper  
& cardboard.

Free recycling of Drum Muster Chemical Drums if they  
are empty, triple washed and have lids removed.

Paint and Oil cans CAN NO LONGER be dumped  
regularly. A muster will be held for these.

### Tipping Fees for Tarago

#### Sorted Waste - Domestic Residence Only

Car, station wagon, small ute or small trailer	\$ 22.00
Medium trailer, large ute or 1-tonne truck load	\$ 25.00
Large trailer load	\$ 35.00

#### Unsorted Waste and Non-Residents Waste

Garbage and trade waste (uncompacted, per cubic metre)	\$ 85.00
Garbage and trade waste (compacted, per cubic metre)	\$140.00
Other unsorted waste - 2 x sorted rate per category	

Hard fill demolition waste not accepted at Tarago

**Animals - Note:** Animal carcasses cannot be dumped at  
Tarago as there are no facilities for burial - please refer  
to Goulburn Mulwaree Council for availability.

Fridges and Air conditioners	\$ 20.00
Car Bodies	\$ 65.00
Tyres - Car & Motorcycle Tyres (each)	\$ 12.00
Truck tyres (each)	\$ 28.00
Tractor tyres (each)	\$100.00

### Our Advertising Charges

Classifieds - Personal (maximum 2 lines)	FREE	
	Month	Year 11 issues)
Small advertisement (business card size)	\$ 6.50	\$ 65.00
Quarter page advertisement	\$12.00	\$120.00
Half page advertisement	\$25.00	\$250.00
Full page advertisement	\$50.00	\$500.00
Double page discount	\$90.00	

Inserts - \$40.00 for 400 inserts into hard  
copies

Typesetting of adverts: \$50

### PAYMENT:

**Cheques:** payable to *Windellama News*  
*PO Box 705, Goulburn. 2580*

**Direct Deposit or EFT:** IMB Ltd; BSB 641.800;  
A/c 200045794 with Name & advert as detail

*\* Unpaid adverts will be cancelled after one  
month*

*\* All advertising copy must be  
accompanied with payment*

All advertising enquiries to

Christine Woodcock

# COMMUNITY INFORMATION

## Windellama Progress Association

Gary Lourigan (President) 4844 5545  
Christine Woodcock (Secretary) 4844 7275

## Windellama Rural Fire Brigade

Rex Hockey (Captain) 4844 5147  
Graham Kinder (President) 4844 5330  
Ellen Sylvester (Secretary) 4844 5407

## Windellama Field Day Committee

Co-ordinator Grahame Woodcock 4844 7275  
Secretary Leanne Lourigan 4844 5545

## Windellama News

Christine Woodcock (Secretary) 4844 7275  
Lyn Jones (Editor) 4844 5843  
Gayle Stanton (Editor) 4844 5156

## Windellama Garden Cub Inc.

Harry Simm (Secretary) 4844 7061  
Sharon King (Treasurer) 4844 5980  
Kevin Muffet (President) 4844 7143

## Windellama Hall Country Markets

Grahame Woodcock 4844 7275  
Lloyd Turner 4844 5214

## Windellama Historical Society

Rex Hockey (President) 4844 5147  
Julian Woods (Secretary) 4844 5270

## Windellama Landcare

Kevin Stewart (President) 0439471714  
Jade Kinder (Secretary) 0449713585

## Windellama CFR

Kevin Muffet 4844 7143

## Windellama School P&C

Shelly Andrews (President) 4844 5630  
Heather Caulfield (Secretary) 4844 5120

## Willow Glen Gardeners

Warren Yates 4844 5350

## Wires (wildlife rescue)

Heather Caulfield 4844 5120  
Southern Tablelands WIRES 4822 3888

## Justice of the Peace

Linda Shannon 0490041167  
Geoff Burns 4849 4330

## Nerriga PSA

Helen Rolland (President) 4845 9115

## FOR ALL EMERGENCIES eg. FIRES / ACCIDENTS PHONE 000

For Mobile users & Landlines



## Important Phone Numbers

### Rural Fire Brigades



Windellama	Rex Hockey	4844 5147
Tarago	Ken Vassel	4849 4652
Taylors Creek	Dave Elward	4849 4240
Mt Fairy/Boro	Brett Daniel	0429964079
Bungonia	Craig White	0407 718607
Gundary	Tony Kent	0437298200
Nerriga	John Rolfe	4845 9160
Bushfire Information	1800 NSW RFS or 1800 679 737	

[www.windellamarfs.com.au](http://www.windellamarfs.com.au) or [www.rfs.nsw.gov.au](http://www.rfs.nsw.gov.au)

**WINDELLAMA PH: 4844 5359 or  
CHANNEL 21/209 Base**



### AMBULANCE

**000**

Ambulance Booking	13 12 33
Goulburn Ambo Station	4827 0444

### Windellama SES

**132 500**

Kevin Muffet	4844 7143
Poison Info. Service	13 11 26
Goulburn Base Hospital	4827 3111

### Police

Tarago Station -	
Snr. Constable Gary Handshaker	4849 4411
Goulburn	4824 0799

### Other

Goulburn Railway Station	4828 5816
Train info & bookings	13 22 32
<a href="http://www.countrylink.info">www.countrylink.info</a>	
Country Energy - interruptions	13 20 80
Lifeline	13 11 14
Kids Helpline	1800 551 800



# June 2016

**Mon**

**Tue**

**Wed**

**Thu**

**Fri**

**Sat**

**Sun**

		1	2	3 Progress Meeting 10.00 am	4 Historical Meeting	5
6	7	8	9	10	11 School Auction & Fireworks  NPSA Cake Stall & Sausage Sizzle	12 <b>St Bart's</b> Service
13 <b>Queen's</b> Birthday holiday	14 Craft Afternoon	15	16	17	18	19 Windellama Markets
20	21 Craft Afternoon	22	23	24	25 Brigade AGM	26 <b>St Bart's</b> Service
27	28 Craft Afternoon	29	30 Garden Club Pot Luck Lunch			