



Published Monthly

Hard Copy Distribution 400 - Website : 6,000 average/month

Windellama, Oallen, Nerriga, Bungonia, Mayfield, Quialigo, Lake Bathurst, Bungendore & Tarago



WINDELLAMA GARDEN CLUB INC HIGH TEA

Date: Thursday October 13th 2016

Time: 11.30am

Venue: Windellama Community Hall

Cnr Oallen Ford Road and Windellama Road

RSVP: Friday October 7th 2016

Contacts: Harry & Tanya 48447061

: Kevin & Margaret 48447143

: Keith 48445971



Cost: \$15.00 per head

Coming Events...

October

- 11 Council Outreach Meeting**
- 12 Progress Meeting 6.00pm**
- 13 Garden Club High Tea 11.30 am**
- 22 RFS Meeting & Training**
- 23 Rotary Swap Meet at Crookwell**
- 26 Big Read bus @ Windellama School
1.30-3.30pm**

November

- 5 Field Day**
- 26 RFS Windellama Get Ready Day**

Annual Subscriptions - please send your details and **\$30** (cheques payable to 'Windellama News') to cover the annual cost of postage.

All cheques please post to:

The Secretary, PO Box 705, Goulburn. 2580

* Unpaid subscriptions will be cancelled after one month

If you have any short articles, anecdotes, or something else interesting about yourself, your family, or the community; please write it down and drop it in our letterbox at the Hall. We will edit it and publish it in the Windellama News.

A LOCKED POSTAL BOX IS AT THE FRONT OF THE HALL, 3444 OALLEN FORD RD, IN THE STONE WALL FOR THE COLLECTION OF ITEMS FOR PUBLICATION

Items left in the box after the deadline will not be collected or included in the News

Articles, adverts, etc may also be sent by email to:

newswindellama@gmail.com

Adverts sent by email will not be inserted unless payment is received by the deadline.

Our Policy on Receipts

The Windellama News makes out a receipt for all advertising payments made to the paper. We don't post out receipts to save cost and we assume that the appearance of the advertisement in the paper could normally be taken as proof of payment. If you require a posted receipt please include a stamped self-addressed envelope with your payment.

It would be greatly appreciated if anyone sending money to the Windellama News would include their name and address and a note saying what it was for and put it in a sealed envelope. This would avoid a lot of confusion and uncertainty .

Notice to advertisers, article submitters & readers

The Windellama News is published and authorised by the Windellama Progress Association Inc. Whilst every care has been taken in the production of the News & publishing to the web page on the community website, the editor takes no responsibility for any inaccuracies, errors or omissions. All such contributors by forwarding advertising, notices, & articles, agree to indemnify the publisher & warrant that the material is accurate & neither deceptive nor misleading, in breach of copyright, defamatory or in breach of any other laws & regulations.

The responsibility for advertisements complying with the Trade Practices Act lies with the person, company or agency submitting such for publication. Original material appearing in this newsletter is copyright. It may be reproduced in part or in whole for the benefit of the community, provided that the source of the material is fully acknowledged. If you have any queries about using material from the Windellama News, please contact the editor.

Inside this Issue.....

Community Noticeboard	3
Windellama Garden Club/SES	7
WIRES	9
SES Member Profile	11
Windellama Fire Brigade	13
Vale Len Ryan	15
Council Outreach Meetings	17
Historical—Tom Bryant	19
Willow Glen Gardeners	21
Big Read bus	23
Big Read bus timetable	25
Big Read bus Timetable	27
Historical Society	29
In Your Garden	31
Church Information	32
Classified Ads	33/34
Community Information	35
Calendar	36

DEADLINE FOR ALL ISSUES IS THE 20TH OF THE PRECEEDING MONTH

YOUR WINDELLAMA NEWS IS PRINTED BY BUSINESS REQUISITES, GOULBURN

Community Notice Board

Thank You!

Windellama Garden Club – bottle your formula and you will make a fortune. Once again the effort at our little community and the Garden Club have only been outdone in their donation by the big boys in town, the Workers and Race Club. What an achievement!! Last year our \$ in vs \$ out left us with a profit of \$115 – so you can see how important the cake auction day is to us.

Every raffle ticket, drink, sausage is important. We paid just under \$45,000 to local families with cancer. This is only achieved by us because of all the generous people involved with the cake day – the hard working garden club, all the cooks, those who donated other items and everyone who attended on the day.

Can Assist and the 59 families we helped they year say thank you very much.

Well done Windellama!!

Bonita Armstrong (Can Assist)



At the Goulburn Mayor's farewell Gary & Leanne Lourigan and Grahame & Christine Woodcock. Presenting Mayor Geoff Kettle and his partner Sharyn Ward with a gift of appreciation for all their help to Windellama Progress and the Windellama community

IN MEMORIAM

Thoughts, prayers and love to Wendy CRISP on the passing of her husband Alan.

Wendy has been a stallholder at Windellama Markets for many years and has also volunteered at numerous events held at the Hall.

Thank you Lyn

A very big thank you to our editor Lyn Jones, for all her help and contributions over the last couple of years. Lyn, you will be greatly missed and we wish you well for the future.

Community Outreach Meetings – 2016

Goulburn Mulwaree Council is hosting an outreach meeting on Tuesday 11 October at the Windellama Hall



The Community Outreach meetings provide an opportunity for community members to meet and discuss Council related issues directly with Goulburn Mulwaree Councillors and senior staff.

The meeting commences at 6:30pm at the Windellama Hall, located at the corner of Windellama and Oallen Ford Roads.



MICK'S MULTI TRADES

ABN: 90 178 544 738

Multi Skilled Tradesman

Windellama NSW

Lic # MVTC 126573

Mob: 0413 059 587

Email: micksmultitrades@gmail.com

Proudly supporting the Windellama community is Mick

A multi skilled tradesman and diesel mechanic by trade

We renovate bathrooms, tiling and floating floors.

We can also build your shed and help you design and convert your shed into a home, installing your water tanks and fencing.

I have always looked after the locals, and turn a hand to any job.

So shoot me an email or phone anytime, you'll be pleasantly surprised at our down to earth rates.



CJ Solar

"Quality Systems that last"



Home, Business or Community Organisations

Custom Designed To Meet Your Energy Needs

- ◆ Stand Alone Systems
- ◆ OnGrid With Battery Backup
- ◆ Grid Connect
- ◆ Clean Energy Council Accredited

Ph: 4849 4225

www.cjsolar.com.au

PREVIOUSLY TRADING AS SUN POWER

LICENSED ELECTRICAL CONTRACTORS (241654C)

Craft, Art, Produce Seasonal (CAPS) Market In Tarago

The Spring Craft, Art, Produce Seasonal (CAPS) Market In Tarago will be held **Saturday 29 October**, from 9am until 2pm at the Tarago Town Hall, Wallace Street, Tarago. It is planned to hold this market quarterly, April, July, October & January.

Tarago is a pleasant drive, half way between Bungendore and Goulburn, with the Town Hall situated near the railway station.

Stallholder items will include: Alpaca garments, antiques, artwork, bags, books, candles, cards, calligraphic items, cider, collectables, crocheted items, cupcakes, cushions, dog coats & treats, free range eggs, fruit & vegetables, greeting cards, hats, herb, honey & beeswax, horseshoe artworks, jams, jewellery, knitwear, lavender products, leatherwork, massages, metalwork, mosaics, olive oil products, paper crafts, plants, preserves, photography, quilts, recipe books, recycled pallet signs, second hand goods, shrubs, soaps, trees, Tupperware, wine, woodwork and roaming buskers.

There will be a community organisation run Cafe with homemade food in the hall, as well as the Keen4Caffeine coffee van near the outside stalls.

A Second Hand Row will have good quality collectables and antiques, something for everyone.

The Food Walk Way is increasing each market with an excellent variety of produce.

A local business will judge the best stall (display and decorative appeal) on the day for a very generous prize.

New stall holders are welcome and stall prices range from \$20 - \$35. Hall sites are much sought after, so there is a waiting list, but outside sites are readily available.

Entry is by Gold Coin donation.

Enquiries to 0429 200 456 or CAPSmarketInTarago@gmail.com, checkout the Facebook page - Market In Tarago.

Jenni Cole



ATTENTION IMPORTANT PUBLIC MEETING

(Sponsored by the Tarago & District Progress Association (TADPAI))

THE TARAGO & DISTRICT MEN'S SHED

A Meeting to discuss the formation of the Tarago & District Men's Shed and to elect a sub-committee to progress this TADPAI project is to be held at the Tarago Town Hall, Wallace Street, Tarago on Sunday 23 October at 4:00 pm. This sub-committee will be run under the constitution of TADPAI which follows the Department of Fair Trading NSW guidelines and procedures.

All residents of the district are invited and indeed encouraged to attend. This is an important development for our district to support Men's Health and needs community support if it is to be done right. The Shed is not just for Tarago residents but also surrounding communities. Please come along and have your say or to simply find out what's going on. **PLEASE SHOW YOUR SUPPORT FOR THIS IMPORTANT PROJECT.**

A recently completed Men's Shed Feasibility Report will also be discussed. For enquiries and/or to obtain a copy of the report which is also available at www.tarago.org.au please contact Neil Shepherd, TADPAI Secretary by email to tadpaisecretary@gmail.com or by phoning 0417673359.

Rainfall Stats

15 June to 15 July



Rosewood , Windellama Road, Windellama	75 / 6 days
Gar-Den , Oallen Ford Rd, Oallen	76 ml / 10 days
Johnno's Store , Oallen Ford Rd, Bungonia	70 ml / 4 days
Tarkierelea , Fernleigh Close, Windellama	104 ml / 6 days
The W's , Readers Road, Quialigo	104 ml / 6 days
Corang Cottage , Braidwood Road Nerriga	60.1 ml / 4 days
Tarago Village	ml / days
Nerrimunga Creek Rd , Windellama	ml / days
Willy Weather	ml / days

NERRIGA HALL

fees for Hire of Hall and Supper Room

Hall

Full Day \$220

Half Day \$110

Supper Room \$66

Kitchen \$110

All fees inclusive of GST

Security/Cleaning Fee \$100

Refundable on Inspection

To book please contact

Helen Rolland 02 4845 9115

helenrolland@bigpond.com



ABN 56756688933

Licence 2009704

General Plumbing

Maintenance and roofing

Drainage

Gas-LPG

Renovation Work

TMV & Backflow prevention

Jason Tolar

M0418227480

evp.plumbing@gmail.com

Windellama Garden Club Incorporated News

Preparations are underway for our High Tea which is to be held at the Windellama Community Hall on the 13th Oct 2016 at 11.30 am.

We ask you to spruce up, pull out your Sunday best and come along to a Windellama style High Tea. There will be an unlimited supply of most varieties of tea. We will also have cakes, tartlets, lamingtons etc, and of course bite sized savouries. We have all sourced cups and saucers, tea pots etc, but may be a little light on cake servers and tea strainers. Be sure that we will improvise as our Grannies did, country folk are like that.

The presentation of the funds raised for Can Assist, Cancer Day Appeal will be presented to their representative at the High Tea.

If you would like to join us then please:

RSVP by Oct 7th Oct. 2016 to

Contacts; Tanya and Harry 48447061

Margaret and Kevin 48447143

Keith 48445971

Cost: \$15.00 per head

We are planning a visit in November to the Cowra Japanese Gardens as these are quite spectacular.

Margaret Burgoine

Publicity Officer

Windellama Garden Club Inc.

Windellama SES First Aid & CFR

We have on going training consisting of Map and Navigation, this is proving to an interesting course. The study of any sort of map, to my mind, is quite fascinating.

The old evergreen of lot numbers being used for an address has come in to focus recently, even no property identification number at all.

A decision was made to open our unit on the same days that the markets operate, but unfortunately no one seems to be interested in seeing what we have to offer to the general public. Does make one wonder, as to whether or not, people really understand what a dedicated lot VOLUNTEERS really are, whether they be RFS VRA SES/CFR ST. JOHN'S, but to mention a few.

Our call outs were fortunately few this past month.

Kevin Muffet

Deputy Unit Controller

Windellama SES/CFR

P R O N I C

A G R I

A mobile service for all your rural living
mechanical repairs

Service & repair of : -

Tractors
Self propelled machinery
Sprayers
Quad bikes
Air conditioning
Ride on mowers
And all general farm machinery

Contact Mathew Nicholls

Tel : 02 4844 5857 Mob 0417 998 938

e-mail : proniacagri@yahoo.com

abn 28 228 073 983

a/c licence no: L058811

Booyong Alpacas

2217 Windellama Rd.

Quialigo. NSW. 2580.

Tel. 02 4844 7267.

Mob. 0417 658730.

Web. www.booyong.com.au

Like us on Facebook

www.facebook.com/booyongalpacashop

Email: booyongalpacas@optusnet.com.au



Breeding Coloured Huacaya Alpacas

since 1997 with a current herd of 175 Alpacas

Alpaca Sales & Stud Services

On Farm Alpaca Shop

selling 100% Booyong Alpaca Products
& Selected Imported Alpaca Garments.

Call us for advice or to visit the farm & view
our Alpacas & Shop.

Buying or selling house or land?

JOHNSON & SENDALL

Incorporating Mullens & Stephen J Lamond

SOLICITORS – CONVEYANCERS

For advice on all your legal requirements

Morris Owen ~ Alison Howarth ~ Tim McGrath ~ Carl Henwood

p: 02 4821 1588 f: 02 4821 9850 e: info@johnsonandsendall.com.au

www.johnsonandsendall.com.au

13 Montague Street Goulburn 2580



Athletics Coach
Personal Trainer
Marina Wenban

Ph: 0439 029 313

Accredited Athletics Australia,

AT&FCA, Fitness Australia



**Big Read bus is here!! Time table on
page 29**



**NSW Wildlife Information,
Rescue & Education Service Inc.**

**SOUTHERN TABLELANDS
BRANCH**

Spring is traditionally a busy time for our volunteers, and 2016 is proving to be no exception. Many creatures need help, especially baby/fledgling birds being blown out of nests during wild and windy weather. However, not all birds on the ground need help. Some, for example magpies, spend a few days on the ground when fledging, fluttering around and learning to fly – with their parents still feeding them. Unfortunately they do look like they're in trouble, and are often unnecessarily picked up by caring and well meaning people. If you see a bird in this situation, try and observe it for a while and only pick it up if it has not been fed by a parent bird for some considerable time, or if it is in imminent danger, eg. dog or cat attack. We in WIRES do our best to raise the animals that come into our care as close to nature as possible, but nothing can replace the natural parent's care for their young.

Magpie and plover swooping can be a problem at this time of year. They only swoop to protect their territory and nest, and will only act in this manner at breeding time. Magpies are territorial and cannot be relocated. In springtime when they have eggs or young, if the offending adult bird was to be relocated there would be no parent bird to look after the young, and they would starve to death. You would also have another Magpie move in as soon as the territory became vacant. Magpies usually build their nest fairly high up in the trees, the basket like nest is made from sticks leaves and grasses, they make use of things like string, rope, wire,



A young magpie in care about to enjoy a juicy treat from the carer's garden. (Photo by Kay Muddiman)

hair and anything else they may think useful. They will reuse the nest year after year doing repair work every new season. Breeding takes place between June and December. The eggs take about 21 days to hatch, and the young spend about 4 weeks in the nest before they leave. The nest is the most dangerous place for a juvenile bird, as predators can easily find them, so the parent birds will encourage the young to leave as soon as possible. They will leave the nest before being able to fly; they will flutter from bush to bush being fed by the parents. You will usually hear them being very noisy at this particular time of the year, as they beg for food from exhausted parents. Magpies are great visitors to your garden, as they eat a variety of destructive insects.

Plovers (or Masked Lapwings) usually lay their eggs after local rains. They lay up to four eggs on the ground in a small depression. Once the eggs are laid the parents are very protective of them. It is this fearlessly protective nature of swooping and screeching that brings them into conflict with people. However, as opposed to magpies, plovers rarely make contact, it's mainly noise and threat. The eggs will hatch in about 28 days and on hatching the chicks are amazingly well coordinated and can see, run and peck up food. The parent gives protection, direction and

(Continued on page 10)

(Continued from page 9)

warmth. As soon as the chick hatches it leaves the nest to follow the parent. We have had plovers nest on our lawn for a few seasons running, and every year once all the eggs are hatched the parents lead them away to a more protected area, and peace returns to the lawn!

The continuous and large amount of rain we had during winter and on into spring has caused many problems for wombats. Their burrows have been flooded and/or washed out causing the animals to move to higher ground. Some places they choose such as under houses or in sheds, may not be the ideal place - not only for the wombats, but also where we humans are concerned! However, most animals will move on when everything dries out, so please be understanding and patient if this happens to you.

Summer is also fast approaching - snake season. An early reminder for people to take care when outdoors, and to keep their yards tidy and clear of rubbish. Not only does this make it less inviting for a snake to take up residence, it also deters mice, rats and other vermin which in turn attract snakes. If you should see a snake that isn't simply "passing through", do NOT attempt to kill it (around 75% of bites occur when people attempt to kill snakes), but try to keep an eye on it while another family member locks up any pets and calls WIRES on 4822 3888. We will give you appropriate advice depending on each individual situation, and if necessary arrange for one of our trained snake handlers to come and relocate it for you.

For help with injured wildlife please ring our branch Rescue number – 4822 3888, our volunteers will be only too happy to assist.

Until next time, take care all – Kay.



Rotary Swap Meet & Market Day at Crookwell Showground, Sunday 23 October 2016

A large variety of new & old goods on offer including collectables, clothing, footwear & normal swap meet items. This year there will be a greater emphasis on show and shine with a large display featuring vintage and veteran cars. The swap meet is again the destination for the 2016 Canberra – Crookwell Charity Cruised organized by the Canberra GT Falcon Club; Contact: info@falcongclubact.com.au)

Outdoor & indoor sites are available starting from \$15 per site & a \$50 lucky stall draw will again be available to participants. Set up from 12noon Saturday, gates open 6.30am Sunday. Free camping on the ground Saturday night with coin operated hot showers available.

Entrance fee for lookers and buyers is \$5 for adults and U12s free. Come along and have an enjoyable day at very little cost & be eligible for some great entrance prizes from our generous sponsors;

- ⇒ Sydney Vintage Car Restorations
- ⇒ Crookwell Hire - \$100 fuel voucher
- ⇒ JD's Rural & Hardware Supplies - \$100 voucher
- ⇒ Lost River Produce - \$50 meat voucher
- ⇒ Paul's Café - \$50 meal voucher
- ⇒ Crookwell Hotel Bistro - \$50 meal voucher

Bookings & information:

Tele: Bill 0428 480 632 or

Email: secretary@crookwellrotary.com.au or

Web: www.crookwellrotary.com.au/swapmeet.html



ALL PROFITS TO ROTARY CHARITIES & LOCAL COMMUNITY PROJECTS

Windellama SES Member Profile

Frances Knights

At the ripe old age of 60 something I joined the local SES/CFR unit six years ago and have had no regrets. My “young” sister in Sydney had joined her local SES some time previously and not to be outdone I decided that it sounded like a good idea. We are not competitive in our family - much.

Since that time, apart from first aid which is most important, I have I learned how to tie knots – that alpine butterfly was a struggle - use the radio properly, learn the ins and outs of safe driving under lights and sirens, don a roof safety harness, help construct anchors and install a safety line across a roof, attaching all the safety features – rockers, karabiners, etc. and actually getting on the roof, which I must say was a major achievement for me. I think, however, I’ll leave the chain-sawing to others.



Our current course is “Map Reading and Navigation” and is proving to be very interesting. Maybe when we finish I won’t get lost when I go for a walk! That will be an improvement.

I have been living in the district for 40 years now and have seen the area grow from a very small community to the thriving place it is today. I like to think I still have much to offer and when asked (and sometimes even when not) will give my opinion on anything and everything.

Windellama and surrounds has always been a vibrant and caring place to live and I feel that if we want it to continue into the future we need to put as much back into the community as we are able and I would urge all newcomers to the area to come and see how SES operates and consider joining our organization.

We have to be fairly self-sufficient in the bush, as we don’t have all the bells and whistles available in the city, and one way to achieve this is to learn how to overcome the pitfalls you may encounter along the way.

Wait another email from Frances as we go to print...

I forgot to mention that I'm still working on the farm - fencing, sheep work but hope with all the lovely rain we have been having lately we are due for a good season at last and the work will be easier. There is nothing worse than having to dig post holes in rock hard, dry ground. I would definitely rather be reading a good book.

A great article from Frances, very interesting. Frances is a valuable member of the Windellama SES and an inspiration to younger female members.

Windellama SES meets on the 2nd and 3rd Mondays of the month at 6.30pm.

Everyone is welcome to come along and find out a little more about us. You’ll find us at the SES Unit in the Windellama Hall complex.

WANTED

**Rural Properties
To Sell – Large or Small**

Over 25 Years experience

Call Allan, Tony or Greg

on 4822 1411

LARGE REWARDS



Professionals

Goulburn

WINDELLAMA VOLUNTEER RURAL FIRE BRIGADE

WINDELLAMA RURAL FIRE BRIGADE

Report all Fires 000
& Emergencies

Brigade enquiries 4844 5359
UHF 21

Yass - 6226 3100



RFS website www.rfs.nsw.gov.au

or

Brigade website www.windellamarfs.com.au

BUSH FIRE DANGER PERIOD SOUTHERN TABLELANDS ZONE

At time of writing it is still not known if the upcoming Fire Season will commence October 1st or November 1st. Due to the continuing wet conditions consideration is being given to delaying the commencement of the Fire Season by a month. However, its commencement will be well covered in the newspaper (Goulburn Post), radio stations (2GN and ABC) and television. In the 'OFF' season the Fire Sign near the Hall will display at the bottom 'Prepare, Act, Survive', whilst during the Fire Restrictions it displays 'Permits now Required'.

During the Non Restricted period you should remember:

- ♦ Yass MUST be notified 24 hours before you light the fire, during business hours 9am to 5pm and by 3.30pm on Friday afternoons, phone 6226 3100.
- ♦ Your immediate neighbours must also be notified.
- ♦ Notify the Brigade as a courtesy to save time, if smoke is spotted, phone 4844 5359.

For more information contact one of the Brigade phone numbers above.

PERMITS ARE REQUIRED DURING THE FIRE RESTRICTION PERIOD

Fines can apply if regulations are not carried out.

**** Windellama Get Ready Day – 26th November 2016 ****

All welcome come along and meet members of the Brigade, enjoy a sausage sizzle.

The Brigade will be holding the Rural Fire Service Get Ready Day at the Windellama Brigade Shed, 3762 Oallen Ford Road. This day will replace the two function days previously held the Open Day and the Information Day. This is an event offering informative discussions on fire safety,

Over the Last Month

The Captain Rex Hockey advised that there weren't any incidents in the last month. This off season has been very quiet, we have had 2 Fire 'call outs' and 1 Motor Vehicle Accident.

Training

If you wish to take part in the Windellama Brigade training or be contacted by email regarding the monthly training details visit the Brigades website and send an online contact form or email windellamarfstraining@gmail.com. For information on training dates, times and scenarios check the Brigade website or contact the Captain Rex Hockey 4844 5147

www.windellamarfs.com.au

MEETING AND TRAINING TIMES TO BE CONFIRMED

General Meeting 22nd October – 6pm **Training** 22nd October – 1pm

No Meeting or Training 26th November

Windellama Get Ready Day – 26th November at the fireshed

Please take care on our roads and see you at the next training and meeting. All welcome.

~~The Loaded Dog Hotel~~



Tarago EST 1848

Hoteliers: Nicole & Mark Ryan www.loadeddoghotel.com 02 4849 4499

1 Wallace Street TARAGO NSW 2580 / 02 4849 4499 / loadeddoghoteltarago@gmail.com

LIVE MUSIC @ THE DOG

October 15th

Benn Gunn

November 19th

Jemma Beech

Social Darts 7.30pm
every fortnight

Come alone or bring a
team



All
welcome

Bingo @ The Dog
11am on 1st
Wednesday of the
month



Community Xmas Party

Sunday 27th November
at 4pm

Live Music
by Wayne
Ryder



The Dog Bistro

Nicole's Fish'n'chips Thursdays 6 - 8pm \$7.50

Home made Pizza all day every day, eat in or take away

Bistro Hours:

Friday & Saturday 6pm - 8:30pm

Sunday 6pm - 8:00pm

Lunches 7 days 12 - 2pm

Vale Len Ryan Late of Coonabarrabran

Hi Folks

I hope you like history because you all should be made aware of how this unit came to be at the point it is at today.

A chap by the name of Len Ryan was an ambo at that time. He lived at "Adanac" Minshall Road, about 4 K from here.

It was around 1998-1999 that Len was having heated discussions with the RFS hierarchy – I should know, as I sat on top of a load of small bales of hay in the hot sun, Len arguing on many occasions that day as to the pros and cons relating to his vision for the future. This vision was to have a RFS first aid service. The 22nd of July 1999 saw this come to fruition.

That class was as follows: Len Ryan, Michael Markut, Sharon Alessi, Joseph Bonney, Mary Bonney, Karen Bonney, Christopher Bonney, Shirley Cornish, Ray Carey, Colleen Gegg, Belinda Hunter, Graeme McFarlane, Joseph Walker, Glenn Walker and Mark Spence.

The RFS has 52 instructors and over 2000 have attended courses and it all started at Windellama.

Graeme McFarland, Shirley Cornish, Pat Freebairn, Anne and Marg Webb, Ken Stevens, Irene Turner, Noel Sylvester and I were taken on by the SES in 2005, fortunately one Phil Brotherton, an ambo and unit controller decided to have a CFR unit at Windellama. This was 2008.

Now the thing to be remembered from this, is that Len Ryan was a visionary, he has left us a legacy that is now in the hands of the newer members of our unit, as us oldies have to give guidance to the new members.

This was dictated to me, Kevin Muffet, over the telephone, not long before Len died at Dubbo hospital.

I first met Lenard Ryan in June of 99 when my eldest son decided to join the fire cadets, I again met him a week later when he conducted a first aid course for the residents of Windellama. I attended this course with my uncle and a neighbour. After our course I approached Lenny and asked if could I learn more, Lenny took me under his wing and over the years taught me all aspects of first aid and beyond.

In 2000 I began to teach first aid through the Rural Fire Service under the supervision of Mr Ryan and Michael Marcut, In 2000 Len had a dream to build a first aid unit to help the injured and sick in Windellama until the Ambulance could arrive; this was met with mixed responses, so Len being Len, he and I started building a trailer to fit out as a mobile treatment room. To fund this we registered this under the Rural Fire service Cadets, and started attending sporting and social events to fund the build and buy supplies.

In the early years it was hard but we soldiered on, we recruited more volunteers and in 2002 we had over 9 members in our unit. In 2003 Lenny and June Ryan went on holiday to

(Continued on page 17)

Countrywide Shower Screens



Shower Screens

• Frameless • Semi-framed • Framed

Mirrors

• Bevelled • Polished

Mick Greenwood
0448 494 220

Fax: (02) 4849 4220

E: countrywideshowerscreens@bigpond.com

Free Measure and Quote

Lowline Cattle

A small beefy, Angus derived breed – quite & easy to handle.

Why Lowlines?

MORE BEEF TO THE HECTARE

- ✓ smaller size means easier handling ✓ higher stocking rates
- ✓ low birth-weights ✓ early maturity ✓ compact bodies
- ✓ excellent feed efficiency ✓ less stress on fencing ✓ less soil compaction



Great for first time cattle owners of any age and gender

Windellama Downs

*Producing quality, Australian breed cattle & sheep
suitable for any size rural holding*

Stock for sale

Commercial or registered stud stock

Mob: 0416 047 488 Ph: 4844 5175

Email: windellamadowns@iinet.net.au

RON WENBAN

** LOCAL ELECTRICIAN

**

Rural * Domestic * Commercial

PH: 0428 445 259

Email: ronwenban@skymesh.com.au

NSW LIC. #174303C

ACT LIC. #2008568



Southern Districts Piano Service

Pianos • Pianolas • Tuning • Repairs
Re-polishing • Removals

Graham Price

02 4844 5329

Industrial • Commercial • Rural • Domestic
Ph 4844 7088 INSTALLATIONS 0418 234 289

ALLARD

ELECTRICAL CONTRACTING SERVICES
SOLAR UTILITIES & ENERGY SERVICES
GAS-OIL COMBUSTION SERVICES

stevenallard@bigpond.com

ELECTRICAL LICENCES:

NSW Lic.No 198855C

NSW Lic.No 498875S

ACT Lic.No 2009576

QLD Lic.No C13290

ACCREDITATIONS

AUS C.E.C. Design & Install Grid Connect
Stand Alone Solar Systems #A3632173

&

Coonabarabran where they bought a farm. They came home, sold up and moved back to Coonabarabran, leaving the first aid unit in my hands.

I contacted Kevin Muffet to assist me in running the unit in 2004. We left the Rural Fire Service and in 2005 the unit as a whole joined the SES again. After the initial induction and training under the SES and completing all tasks assigned to us, in 2008 the same 9 residents from Windellama sat and passed their Community First Responder over a 8 week period. After this time all nine residents became community responders in association with the NSW Ambulance service which meant these residents would be called to the sick and injured and perform first aid until the Ambulance would arrive and the Paramedics would take over. This service has grown and grown over the years, 8 years to be exact, they now have their own shed at the hall, so one man's dream with the hard work of some extraordinary people, has now become a reality.

Memories by Graeme McFarlane

Council Outreach Meetings



Goulburn Mulwaree Council has confirmed the calendar for the 2016 Community Outreach meetings.

The meetings will provide an opportunity for community members to meet and discuss Council related issues with Councillors and senior staff; rural communities are encouraged to have their say on council matters and projects.

The 2016/17 budget included an allocation of over \$11.7 million over four years to rural roads and bridges, while \$100,000 is allocated each year to the Village Discretionary Fund.

Mayor Geoff Kettle emphasised the importance of these meetings. "Ensuring that we take the chance to meet with all communities within the LGA is incredibly important. I'd encourage everyone to take advantage of the meetings to voice your thoughts and ideas."

The 2016 Outreach Meetings will also be the first chance for new councillors to engage with rural communities within their new roles. Council elections will take place this Saturday, 10 September, with 9 councillors to be elected for four years.

2016 Community Outreach meeting schedule

Windellama	6:30pm, Tuesday 11 October at Windellama Hall
Goulburn	5:30pm, Tuesday 18 October at Council Chambers
Marulan	6:30pm, Tuesday 25 October at Marulan Hall
Parkesbourne	6:30pm, Thursday 3 November at Parkesbourne Uniting Church Hall
Tarago	6:30pm, Tuesday 8 November at Tarago Hall
Towrang	6:30pm, Thursday 10 November at Towrang Hall
Tallong	6:30pm, Tuesday 22 November at Tallong Hall

Nirvalley Homestead NURSERY



629 Cullulla Rd, Tarago

PH **4849 4481** 

M 0419 257 663 E. nirvalley@optusnet.com.au

Find us on FACEBOOK



All our plants are ideal for local conditions and fully acclimatised

- Big range of natives and shrubs
- Conifers, Hedging, Windbreak
 - Paddock & Feature trees
- Advanced Trees • Tube stock
- Fruit Trees, Nuts & Berries

FRUIT TREES

**Big range still available,
all potted at bare root prices.**

**New varieties in stock -
CHERRY GUAVA, LOQUAT
FINGER LIMES pink, red, green**

NEW... RARE CRAB APPLES

**Coming soon... GOJI BERRY
more varieties of Citrus**

SPECIALS

DAPHNE pink/white 17cm pot \$15

FLOWERING PLUM

**Prunus Blireana - dark foliage,
double pink flowers 30cm pot \$30**



TARAGO PRE-SCHOOL

Open 5 days a week

Monday - Friday
Children 18 months - 6 years

Standard Rate - \$35/day

Casual and Half days available

Subsidised rates on application



We follow the curriculum set out by the

Early Years Learning Framework

Preschools NSW - Education for Life



Ph. 4849 4427

tarago.preschool@gmail.com

Our staff are Diploma & Cert III qualified

or

Studying the Cert III in childcare



ORIGINAL WINDELLAMA POST OFFICE FOUND

The Windellama Post Office was established on 1 June 1863 with Richard Bull, a farmer at Windellama as the first Postmaster. Richard was born in 1833 at Liverpool NSW into a large family, his parents being John and Mary Bull.

With his brother John, Richard moved to Goulburn and they set up a wheelwright and coach building business in Grafton Street. Richard was married in 1855 to Maria Rowley of Liverpool.

In 1861 the firm of J and R Bull Wheelwrights, closed and Richard bought a property at Windellama and became a farmer and established a dairy farm.

Richard was paid £12 per annum. The post office was located on Portion 133 Parish of Cullulla. This was the land once owned by Richard Popham and was just across the Windellama Creek from where the post office was located

at a later date when Edgar Fife was post master.

Previously I had no idea where the original post office was located but by chance while looking for something else I came across the following advertisement.

TO LET

A good DAIRY FARM, 690 acres at Windellama, lately occupied by the late R Bull.

(*Sydney Morning Herald* 13 February 1864 page 12)

On looking at the Parish maps for Yarralaw and Cullulla I found that there was only one 690 acre portion, on these maps, Portion 133 Parish of Cullulla.

The *Goulburn Herald* of 5 March 1864 page 3 also had the following advertisement for the stock and household items.

After Richard Bull's death the post office was taken over by Mrs Elizabeth Cartwright, a position she held for the next 30 or so years.

(Tom Bryant 20 July 2016)

Monday, 7th March.

SALE AT WINDELLAMA.

By order of the Trustees of the late Mr.
Richard Bull.

**CATTLE, HORSES, DRAYS, FARM-
ING IMPLEMENTS, HAY
HOUSEHOLD FURNITURE, &c.**

P. DIGNAM AND CO.

Have received instructions from the Trustees of the
late Mr. RICHARD BULL, to sell by public auction,

At Windellama,

ON MONDAY, 7TH MARCH,

At eleven o'clock,

FIFTY HEAD CHOICE DAIRY CATTLE, including—

12 cows with young calves at foot

20 pigs, lot of poultry

4 excellent draught and saddle horses

Four-horse dray, harness

3 ploughs, harrows, roller

Blacksmith's bellows, anvil, and tools

Set wheelwright's tools

Cheese vats, dairy utensils, paints, oils

25 TONS PRIME OATEN HAY, &c., &c.

Also, the HOUSEHOLD FURNITURE, includ-
ing—

Bedsteads and bedding, chest of drawers

Tables, chairs, sofas

Kitchen utensils, &c., &c., &c.

* * The sale will commence at eleven o'clock, and
purchasers are requested to facilitate the sale by
attending punctually.

Terms—Cash.

359

Rusty Balls

- . Natural bush soaps
- . Pet shampoo
- . Anti-bug balls - natural insect repellent
- . Blind Baking Balls
- . Hand made ceramics

Gary & Denise Johnson

4844 5087

sales@rustyballs.com

www.rustyballs.com

SHEPHERD'S HILL NURSERY

321 George St, Marulan

Ph 4841 1404

Fax: 4841 1454 Mobile: 0413 047 105

Look for the house on the hill

For all your garden needs &
acclimatised plants

**Potted colour, Seedlings,
Bulbs, Fruit trees, Ornamental
trees, Windbreakers,**

Shrubs and more

**Potting Mixes & quality soils &
mulches.**



A1

**SEPTIC TANK
&
GREASE TRAP
CLEANING SERVICES**



0408 483 943

Bob Baird Goulburn

PH: 4822 3290

7 DAYS—SERVICING ALL AREAS

BUSINESS REQUISITES

Sales & Service

- . Photo Copiers
- . Fax Machine
- . Cash Registers
- . Computers
- . Stationery
- . Consumables

Ph: **4821 5109**

E: **bus_req@ozemail.com.au**

10 Russell Lane, Goulburn

Willow Glen Gardeners

<http://www.whispersfromwillowglen.blogspot.com>

Brilliant sunshine, cloudless skies, cool but not freezing, no wild Windellama winds and warm in the sun – we couldn't have asked for better weather for our garden club day at Nirvalley Plant Nursery on Cullulla Road. Caroline Campbell joined us to hear about our frivolities with our gardens and said they always have kangaroos/wallabies eating their plants. Bridget has put sticks/stakes everywhere to try and stop the wallabies from demolishing her garden but to no avail. John & Caroline put up deer fencing to deter their attacks, however possums have been decimating their roses and brazenly walking up & down their verandah looking for a chomp. Caroline has found aphids on her hellebores already – be on the lookout. They said that they've had so much rain it's like driving through a lake to get from the road to their house, but better than no rain.



Tony advised that Diggers seeds & plants are now available in Canberra at The Heritage Nursery (near Yarralumla). We hope next year to have a day at Canberra's Botanic Gardens and maybe the Arboretum and The Heritage Nursery (yet to be planned). Joy brought bags of strawberry plants for us to share. Peter & Maria are looking forward to their tulips flowering soon. Their house was built in 1837 as a slab hut and they've worked constantly over the years to rebuild & renovate. They now have a Newfoundland pup – this will soon look like a small horse on a small block. Warren said that for 2015 they had 459 mls of rain but so far this year (to early September 2016) they have had 541 mls. Good rainfall so far this year. It's time to spray fruit trees for leaf curl while they are in blossom before the leaves appear. Judy is still in hospital recovering from her knee replacement – best wishes for a speedy return to the garden.



It was interesting to learn about Nirvalley's history. The original cottage was built in 1905 but was completely undermined by wombats and collapsing when Peter & Caroline bought the property over 20 years ago, so the council said it was too dangerous and must be demolished. However, there are still traces of the original gardens including snowdrops and unusual daffodils with many rows of bright yellow ruffled petals - beautiful. Many suggestions from our members to deter wombats from digging their holes under garden beds (or houses) included strobe lights or movement detectors outside or blood & bone (which dogs like to roll around in), dynamic lifter or peeing in the hole (at night to prevent embarrassment, hehehe).



(Continued on page 23)

WINDELLAMA PLAYGROUP

at

Windellama Public School

Each Thursday

9.30am – 11.30am



BYO snacks - tea & coffee supplied

Qualified art teacher visiting each fortnight

Bring your bubs & toddlers for a fun morning

Music, stories, sand-play, free-play, art, craft.

FREE!



JCF Contractors are the specialist team to ensure your project has the manpower to complete all your key projects on time, to budget and at the highest level of quality.

No matter what your project, JCF can assist you in:

- Earthmoving
- Road Works
- Driveways
- Site Works
- Arenas
- Demolition
- Footings & Piers
- House Excavation
- Shed Sites
- Rubbish Removal
- Septics
- Landscaping
- Trenching

Call Jon today for your FREE quote
0428 624 966

Goulburn and surrounding areas



Peter Campbell is always willing to offer advice on plants for our region and he even has koala food trees – Tasmanian Blue Gum (*Eucalyptus Globulus*) in small pots. There is a huge range of fruit trees including stone, citrus and dwarf trees plus hundreds of other trees, ornamentals & plants all acclimatised for our region. We are so lucky to have such a great local plant nursery right on our doorstep – and if it's not there Peter can get it in for you. Don't just drive past – call in, have a look, talk to Peter about trees or plants for your place and get them locally – it's good to support our friends & neighbours, especially with such variety & reasonable prices. Peter is also a landscaper, servicing from the Southern Highlands to Canberra, so if you're in the market for that then he's your man. Thank you Peter & Caroline for inviting us to join you on such a glorious day.

Our next meeting will be Tuesday 4th October at Bridget & Frank's home, 172 Mulwaree Drive, Tallong. Please bring something to share for morning tea. We'll then go to Joy & John's home at Tallong to enjoy lunch. Joy is kindly cooking a pasta dish for us, we just need to bring a salad to share. Everyone is welcome to come and share garden walks, food and friendship.

Liz-Ann

Nerriga Gardeners

Due to the inclement weather and low numbers the trip to the Araluen was postponed until the peaches come into season in December. Also we had missed the majority of the blossom with only the late varieties still in flower. Instead a few of us gathered at Corang Cottage and had coffee and cake. Later I emptied the back of the ute which had a nice pile of soil and mushroom compost and made up some bags to grow early potatoes. The idea is that the potatoes start to grow in the bag with about 6 inches of mix and as they grow more mix is added until the bag has about 2 foot of soil in it and then the potatoes are supposed to produce layers of new potatoes which can be slowly harvested from the bottom of the bag by cutting a hole and ferreting about in the dirt. We will see if it works or is too much trouble and no better than growing them in the ground and doing a one off harvest. After a couple of frosts on Saturday and Tuesday morning the wisteria is looking a bit sad but then there won't be as much fallen blossom to gather up! The lilies had mostly sprouted and they got sugar cane mulch caps for the 2 nights which appears to have worked. The late daffodils are managing a good show despite the wind and then rain followed by hot days but the Bowerbird is still picking the best blooms! He has also taken a liking to the primrose flowers and the grape hyacinths are good for background at the bower.

Next month the meeting day is being changed to Thursday 20th due to work changes for some members and as yet the venue is undecided. November if enough people are interested an excursion to the Eurobodalla Botanic Gardens at Bateman' Bay can be undertaken and December will be the trip to the Araluen to get peaches and nectarines. Anyone and everyone is welcome to join us and the meeting point will be 7184 Nerriga road at 9am for the Nov and Dec trips. Any further info contact Kay Hamer on 48459021 or kahamer@activ8.net.au.

During the rest of September and into October there are lots of flower events such as Floriade, Tulips at Sutton, Tulip Time in the Southern Highlands and several gardens are open to the public for a small charge. See the website myopengarden.com.au for details of open gardens. Also 23rd October there is a Spring Concert and lunch at Palerang Homestead see trybooking website.

ACOM DESIGN

PO Box 806,
Goulburn 2580

Yarralla,
Oallen Ford Rd
Bungonia 2580

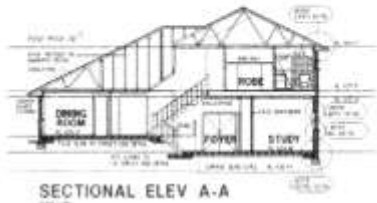

Robert C Everingham

Building Designer & Draftsman

New Homes, Alterations & Additions
Duplex, Villa, Townhouse Developments
Rural, Commercial, Industrial Buildings
Free Quotes - Competitive Rates - Prompt Service
Energy Efficient (SEDA), Eng Dwgs: Mech, Struct, HVAC

TEL 4844 4321

MOBILE 0417 682 022

FAX 4844 4323

EMAIL acomdesign@bigpond.com.au



MEMBER
STANDARDS AUSTRALIA



MEMBER
BUILDING
DESIGNERS
ASSOCIATION
OF NEW SOUTH WALES INCORP

Heard of Wiltipoll Sheep?

The Wiltipoll is a hardy, prime lamb, wool shedding breed developed in Australia



- ✓ Full wool shedding – no costs of shearing
- ✓ Fly lice & grass seed resistant
- ✓ No jetting dipping or mulesing
- ✓ Stays in allocated paddock
- ✓ Superior quality meat sheep
- ✓ Ideal for organic lamb production - consistent multiple births

Windellama Downs



Stock for Sale

Commercial or Registered Stud Stock

Mob: 0416 047 488 Ph: 4844 5175

Email: windellamadowns@inet.net.au

yarralaw springs wines

Goulburn & Southern Tablelands Newest Winery

Cellar Door Upcoming Open Days

Hours – 11am to 4:00 pm

Sunday: 2 October

Sunday: 9 October

Sunday: 16 October

~check website for any changes or

call prior for a drop in visit or purchase anytime ~
25 kms down Windellama Road from Goulburn
turn left into Muffets Road

email: admin@yarralawsprings.com.au

web: www.yarralawsprings.com.au



The Big READ bus

The date is set for the official launch of the Big READ Bus; come down to Belmore Park at 2pm on Saturday 8 October to discover Goulburn Mulwaree's new mobile library.

Goulburn Mulwaree Council will be officially opening the doors of the Mobile Library as part of an exciting afternoon that will include snakes and ladders, sausage sizzle, cupcakes and coffee.

Following the launch the mobile library will transform into a children's outdoor reading and library area with chairs and tables for families to sit and read before the Pictures and Popcorn in the park movie begins.

The Big READ Bus is eco-friendly, and is equipped with rooftop solar panels which will provide clean energy for on-board equipment. The mobile library will be fitted out with wireless internet, computers and devices such as iPads, Samsung Galaxy and Kobo, as well as holding up to 3000 library books and other items for loan.

From Monday 10 October the Big READ Bus will be visiting rural areas, schools, nursing homes and retirement villages to provide library services to members of the community who can't easily access the Library in Bourke Street. Please find attached the timetable for 2016.

Library members will be able to use the bus to borrow a wide variety of books, movies and music. Our on-board librarian will also be available to answer questions, reserve library items and teach people how to use their devices to loan e-books and access a range of other online resources; all free of charge.

The aim of providing a mobile library is to create greater access for resources, and to build a safe and welcoming environment for the community to share ideas, learn and play. The library, by bringing people together, hopes to provide a unique and exciting space that will foster the growth of stronger and more connected communities.

As part of the launch there will also be a 'pop up library' on the morning of 8 October, as part of the Pathways to Hope event in Belmore Park. The Big Read Bus will have information in relation to health, wellbeing and cancer prevention.

The purchase and fit out of the Big READ Bus has been made possible through funding from the State Library of NSW's State Government Public Library Infrastructure Grant, administered by the Library Council of NSW.

Michelle Feely
Mobile Librarian

P: 02 4823 4541 | F: 02 4823 4440

Goulburn Mulwaree Council | Locked Bag 22 Goulburn NSW 2580

W: www.goulburn.nsw.gov.au | [Find us on Facebook](#)



Better Barbeques



At Barbeques Galore you'll discover a whole new world of outdoor entertaining.

A lot of places are selling outdoor products, like Barbeques. The difference is WE can show you how to use them!

We've got a huge range of the latest aluminium, wicker and timber settings to suit both the size and style of your backyard.

4821 1292 or 4821 4889

388 Auburn Street, Goulburn www.barbaquasgalora.com.au

**LARGE RANGE
GREAT PRICES
FRIENDLY STAFF
GREAT SERVICE**

**BARBEQUES
GALORE**

BBQBahar.

The Big **READ** bus Timetable October – December 2016

DAY	STOP	TIME	DATES		
			OCTOBER	NOVEMBER	DECEMBER
WEEK 1					
Monday	Southern Cross Tenison Apartments, 19 Upper Sterne Street	10am - 12:30pm	24	14	5
Tuesday	Tirrana Public School	8:30 - 11am	25	15	6
Wednesday	Windellama Public School	1:30 - 3:30pm	26	16	7
Thursday	Brewers Centre, Marulan	10am - 12pm	27	17	8
Thursday	Marulan Public School	1:30 - 3:30pm	27	17	8
WEEK 2					
Monday	Chatsbury Gardens, 52 Chatsbury Street	12:30 - 2pm	10, 31	21	12
Monday	Clinton Villas, Clinton Street	3 - 4:30pm	10, 31	21	12
Tuesday	Masonic Village, 10 Long Street	9:30 - 11:30am	11	1, 22	13
Wednesday	Bungonia Hall	10am - 12pm	12	2, 23	14
Thursday	Tallong Public School	1 - 2pm	13	3, 24	15
Thursday	Tallong General Store	2:30 - 4pm	13	3, 24	15
WEEK 3					
Tuesday	Tarago Hall	1 - 3:30pm	18	8, 29	20
Wednesday	Wollondilly Gardens, 10 Mary Martin Drive	1 - 3pm	19	9, 30	21
Wednesday	Legacy Lodge, Lagoon Street	3:30 - 4:30pm	19	9, 30	21
Thursday	Warrigal Care, 7 St Aubyn Street	9:30am - 12pm	20	10	1, 22
Thursday	Gill Waminda, 4 Mary Street	2 - 4:30pm	20	10	1, 22

The Big **READ** bus

Locked Bag 22, Goulburn NSW 2580

Mobile Library Ph: 0498 007 743 Library Ph: 4823 4541

Email: library@goulburn.nsw.gov.au

Website: www.gmlibrary.com.au

Spring is here , spring into Goulburn

Sand & Soil

02 4821 8244

- Decorative Gravel
- Garden Soils
- Pavers & Blocks
- Sand
- Garden Mulches
- Compost
- Road Base
- Granites
- Rocks / Retaining Walls
- Concrete Products
- Pipes
- Green Waste Recycling
- Aggregates
- Firewood
- Hitech Concrete Products
- Tools, Stencil Options & Colours



Courtesy trailer and delivery available

TRADING HOURS

MONDAY – FRIDAY 7AM-5:30PM

SATURDAY 7AM - 4PM

SUNDAY 9AM – 1PM

www.divalls.com.au

CRN OF BRAIDWOOD & BUNGONIA RD
GOULBURN NSW 2580





Hello Everyone,

Our next excursions will be to “Mullengullenga” the Bronte School on the Hawke’s property, a special thank you to the family for the opportunity to see the school again. We will also visit the Bronte Church and cemetery.



Date: 22nd October.

Time: 10am at the Museum

Cost: \$13 morning tea (Damper on the menu) and lunch.

Bookings essential, ring one of the members listed below or contact Joanna 48445125

Hope to see you, will be a great day.

Windellama History is preserved in our wonderful museum, with lots to look at and lots to talk about, so come and visit on the next market day.

We have a selection of history books by local authors Tom Bryant & Rex Hockey, *for sale as well as the ever popular “Wild Windellama” by Carina Clarke.*

The museum is open on Market Days - every third Sunday of each month, from 9am till 1pm and by arrangement.

The Next Meeting will be on Saturday 8th October 2016 10am at the Museum

NEW MEMBERS and GUESTS ARE ALWAYS WELCOME

For any enquiries please contact:

Rex Hockey: 48 445147

Marcia Tatam: 48 216421

Julian Woods: 48 44 5270

WINDELLAMA HALL COUNTRY MARKETS

Sunday 16th October

9am to 1pm



Homemade Jams & Preserves
Pre loved toys & tools
Locally produced honey
Lots for the sewing enthusiast
Hand made baby treasures
Gourmet foods
Wooden Nick Nacks & Toys
Rawleigh Healthcare
Scented candles
Hand made knitted goods

Food and refreshments
New stallholders welcome

Enquiries *Grahame Woodcock*

48447275

Plenty of parking
Museum open



With the worst of the frost over, spring trees and shrubs are flowering, such as crab apple, flowering peach, cherry, magnolias, shrubs such as golden forsythia, weigelleas. This month climber such as clematis should also be flowering.

VEGETABLES SEED

Sow seeds of carrots, parsnips, beetroot, peas, cabbage, silver beet, radish.

Curcubits; cucumber, zucchini marrow, melon (rock melon and watermelons), Pumpkins, squashes, all these plants need a warm soil to grow, also some old compost and complete fertilizer, good drainage and a warm sunny spot.

Capsicums, and tomato but protect from any late frost.

Sweet corn requires a garden which is built up with compost and a dressing of complete fertilizer just before seed is sown directly into the soil. Plant in blocks this allows the pollen from the male flowers or tassels at the top of the plant has the best chance of falling on the female flowers half way up the stems. Space rows 60cm apart.

Beans seeds, celery and parsley can also be sown.



FLOWERS

Ageratum, alyssum, asters, balsam, carnation, cosmos, dianthus, larkspur, linaria, lobelia, liverstone daisy, marigold, nasturtiums, pansy, petunias, phlox, poor man's orchid(schizanthus), portulaca, snapdragons, verbena, seeds and seedlings can go in now.

Dahlia; seedling of the dwarf varieties, which only grow to 60cm can also go in.

The taller dahlia plant tubers, in good compost soils and place the stake them for support. As plants grow a side dressing of complete fertilizer, also soluble fertilizer used over the foliage every month will ensure plenty of blooms. They like a area with plenty of sunshine.



Remove winter weeds before they set seed, and chip spring weed seedlings with a hoe.

Feed spring bulbs after they have finished flowering. Fertilize azaleas, rhododendrons, magnolias and camellias.

Trim winter-flowering natives such as wattle and crowea when they finish their main flush.

Craft @ Windellama Hall

We meet from the second Tuesday of the month 1—4 pm.

For more information please call Irene Turner on 48445 214.

CHURCH INFO

Catholic Church Services

Parish Priest: Fr. Dermot McDermott

Assistant: Fr. Assin

Deacon: Chris Van Gessel

Presbytery & Parish Office
Phone 4821 1022

Sunday Mass will be at 8am on the 2nd & 4th
Sunday at St. Patrick's **Marulan**.

Mass Times in **Goulburn** are:

Saturday Vigil Mass:

5pm at St. Peter & St. Paul's

Sunday: 7am. at Our Lady of Fatima,
Nth. Goulburn

Sunday: 10am. at St. Peter & St. Paul's

St. Joseph's Church, Tarago

Enquiries: 4821 1022



CHURCH SERVICES

St Bartholomew's Windellama

All Services now at St. Barts

9th October

23rd October

Services now start at 10.30 am

Reverend Peter Bertram

Fees for Hire of Hall or Supper Room at Windellama Hall

*HALL ALL DAY	\$200
DAY 4hrs or less	\$100
EVENING/NIGHT**	\$200

*Includes Supper Room & Kitchen

** \$2 per hour for heating

SUPPER ROOM (Includes Kitchen)

ALL DAY	\$80
DAY 4hrs or less	\$40
EVENING/ NIGHT	\$100

Use of the premises prior to your booked
function will incur a surcharge of
Supper Room Fee

**To Book please ring W. P. A. Secretary,
Christine Woodcock on 4844 7275**

St. Andrews (Anglican) - Tarago

2nd Sunday 9am

St. John's - Lake Bathurst

4th Sunday 9am

NERRIGA

ANGLICAN CHURCH SERVICES

Held at Nerriga Church

2nd Sunday each month at 2pm

(Except Easter & Christmas)

All Welcome

Classified Advertisements

All personal classifieds are FREE & also included in the Tarago Times
We run your advert until you let us know when you have sold it or gained it

GENERAL FOR SALE

Sony Bravia HD 42" TV \$180 ono Ph 48445156

Teak entertainment unit, with two glass door display. 6x4 foot. \$75.00 ONO.

Double bunks, Metal, with ladder, new innerspring mattresses. \$125 ONO

Two wooden bed side tables with cane draws. \$50 for two. Ph. 4849 4480

1 x **King Single bed** \$200; 1 x **Single bed** \$150; 1 x **Single bed** \$100; **Dressing table/ chest of drawers** (8) \$150; 1 x **Glass TV table** \$150; 1 x **Glass coffee table** \$50 Ph 0411 421 416

Lounges - 1x3, 1x2 + ottoman - yellow fabric, Matching chair in navy blue. All GC. Offers over \$500 considered. 4849 4222

Desk - large timber, 2xdraws/storage under. Leather inlay + matching 2drawers file cab. Ergo office chair. All VGC. \$400 ONO 4849 4222

Firewood. \$150 per load. Ph 4849 4520 for delivery

Firewood. 2 tonne truck load \$430, ½ truck load \$250. Ph 0401 241 646

2nd hand container for sale. \$3000 not/neg. In Goulburn area. Buyer responsible for all transport costs. 0435798941

ANIMAL RELATED FOR SALE

Parrot Cage on stand, good cond. \$150 ONO. Ph 0429 006 745

Saddles, good condition, \$350 & \$200. ONO. Riding helmets \$30 and \$20. Also other gear: bridles, leather straps, etc. Ph 0434 286311.

Miniature Shetland Gig well balanced, hardly used, some harness, pneumatic tyres, lightweight \$730 ono Ph 62301774 or 0417749064

ANIMALS FOR SALE

Young Peking/Orpington cross drakes - \$12 each (Drakes Only). Ph 48459147, after 6pm

Piglets - different ages so different prices. Ph Bob McDonald 0429 494 331

Alpacas - lots of different colours & ages.

From \$250 each Phone Jacki 0428 298 157

Quarrions (cockatiels) - \$8 each
Ph 4845 9147 after 6pm

Horse part Arabian, 3 yrs old, regd, 14.2 hh, chestnut mare. \$3,000 Ph 0429 461 490

Alpaca Wethers Variety of Colours, ages 12 months – 3 years. Halter Trained Wethered, Needled & Shorn. \$400.00 each. Phone 4844 7267. Faye & Keith. Quialigo.

15 milking goats. A mixture of male and female. Friendly and well behaved. Price negotiable depending on number purchased. Ring Julia 42761489.

One six month old pig for sale - approx. cost \$150. Please call Julia on 4276 1489

AGISTMENT

Horse Agistment available at 41 Burrabinga Road Tarago. Please phone 0429 461 490 for enquires

CARS, BIKES, TRAILERS, etc. FOR SALE

Camper Trailer Queen sized bed with large room. Plenty storage room. Comes with zipon canopy/shelter. Easy to erect/store/transport. \$3500 ono Ph 62301774 or 0417749064

Toyota Hilux 1998 tray with sides 2.7 petrol Good Tyres. Goes Well. Un/Reg. \$800. 48445500

RURAL RELATED FOR SALE

Lucerne Hay Prime soft green small bales \$15 8 x 3 x 3 bales of lucerne or beardless wheaten available phone 0428493194

Stanbury Electrical 75 amp battery charger - new condition, used twice only for Solar batteries - \$1200. Pho 48459147 after 6P.M.

Gallagher Lightning Diverter for electric fence energiser protection. New & unused - \$30 Ph: 4844 5843

WANTED

Knitting wool for volunteer knitters for charity. Any leftover wool, any ply, gratefully accepted. Ph Denise 4844 5087

Instantaneous LPG Gas Hot Water system 16-20 litres per minute flow rate, working or not. Ph Gary or Sharon on 4844 5980

Classified Advertisements cont

WANTED_{cont}

Galvanized farm gates 2 of 3.6 meters wide
Galvanized C purlins 100mm / 150mm or 200mm
3metrs to 6 meters long
ph Gary or Sharon 4844 5980

VT Commodore 1997—2000 5 litre V8 any
condition running or not ph Michael on
0413146140

Horse agistment for mini mare from
November to May to avoid coastal itch. Please
call Tanya 4456 5589

SERVICES

Belinda's pet minding

Why stress your pets out by putting them in
Kennels or boarding and saving on having to get
them vaccinated to put them in boarding.

I will come to you . Leaving your animals in their
own homes. I have Vet Nurse experience of
10yrs .

I have a miniature pony stud and also breed and
show guinea pigs. I will feed Horses , Dogs, Cats,
Goats, Sheep, Chickens Ducks,. Medicate
animals daily if needed .

Servicing Windellama , Bungonia, Quialigo and
Goulburn.

Contact Belinda on 48447168 or 0497179799

TARAGO TRANSFER & DRUM MUSTER STATION

Open Friday to Monday 8.00am - 4.45pm

Card required for household waste, or fees apply.

Free recycling of: Plastics, tins, batteries, glass, paper
& cardboard.

Free recycling of Drum Muster Chemical Drums if they
are empty, triple washed and have lids removed.

Paint and Oil cans CAN NO LONGER be dumped
regularly. A muster will be held for these.

Tipping Fees for Tarago

Sorted Waste - Domestic Residence Only

Car, station wagon, small ute or small trailer	\$ 22.00
Medium trailer, large ute or 1-tonne truck load	\$ 25.00
Large trailer load	\$ 35.00

Unsorted Waste and Non-Residents Waste

Garbage and trade waste (uncompacted, per cubic metre)	\$ 85.00
Garbage and trade waste (compacted, per cubic metre)	\$140.00
Other unsorted waste - 2 x sorted rate per category	

Hard fill demolition waste not accepted at Tarago

Animals - Note: Animal carcasses cannot be dumped at
Tarago as there are no facilities for burial - please refer
to Goulburn Mulwaree Council for availability.

Fridges and Air conditioners	\$ 20.00
Car Bodies	\$ 65.00
Tyres - Car & Motorcycle Tyres (each)	\$ 12.00
Truck tyres (each)	\$ 28.00
Tractor tyres (each)	\$100.00

Our Advertising Charges

Classifieds - Personal (maximum 2 lines)	FREE	
	Month	Year 11 issues)
Small advertisement (business card size)	\$ 6.50	\$ 65.00
Quarter page advertisement	\$12.00	\$120.00
Half page advertisement	\$25.00	\$250.00
Full page advertisement	\$50.00	\$500.00
Double page discount		\$90.00

Inserts - \$40.00 for 400 inserts into hard
copies

Typesetting of adverts: \$50

PAYMENT:

Cheques: payable to Windellama News
PO Box 705, Goulburn. 2580

Direct Deposit or EFT: IMB Ltd; BSB 641.800;
A/c 200045794 with Name & advert as detail

*** Unpaid adverts will be cancelled after one
month**

*** All advertising copy must be
accompanied with payment**

All advertising enquiries to

Christine Woodcock

COMMUNITY INFORMATION

Windellama Progress Association

Gary Lourigan (President) 4844 5545
Christine Woodcock (Secretary) 4844 7275

Windellama Rural Fire Brigade

Rex Hockey (Captain) 4844 5147
Jim Meehan (President) 4844 5554
Ellen Sylvester (Secretary) 4844 5407

Windellama Field Day Committee

Co-ordinator Grahame Woodcock 4844 7275
Secretary Leanne Lourigan 4844 5545

Windellama News

Christine Woodcock (Secretary) 4844 7275
Lyn Jones (Editor) 4844 5843
Gayle Stanton (Editor) 4844 5156

Windellama Garden Cub Inc.

Harry Simm (Secretary) 4844 7061
Sharon King (Treasurer) 4844 5980
Kevin Muffet (President) 4844 7143

Windellama Hall Country Markets

Grahame Woodcock 4844 7275
Lloyd Turner 4844 5214

Windellama Historical Society

Rex Hockey (President) 4844 5147
Julian Woods (Secretary) 4844 5270

Windellama Landcare

Kevin Stewart (President) 0439471714
Jade Kinder (Secretary) 0449713585

Windellama CFR

Kevin Muffet 4844 7143

Windellama School P&C

Shelly Andrews (President) 4844 5630

Willow Glen Gardeners

Warren Yates 4844 5350

Wires (wildlife rescue)

Southern Tablelands WIRES 4822 3888

Justice of the Peace

Linda Shannon 0490041167
Geoff Burns 4849 4330

Nerriga PSA

Helen Rolland (President) 4845 9115

FOR ALL EMERGENCIES eg. FIRES / ACCIDENTS PHONE 000

For Mobile users & Landlines



Important Phone Numbers

Rural Fire Brigades



Windellama	Rex Hockey	4844 5147
Tarago	Ken Vassel	4849 4652
Taylors Creek	Dave Elward	4849 4240
Mt Fairy/Boro	Brett Daniel	0429964079
Bungonia	Terry Lewis	0408 223 380
Gundary	Tony Kent	0437298200
Nerriga	John Rolfe	4845 9160
Bushfire Information	1800 NSW RFS or 1800 679 737	

www.windellamarfs.com.au or www.rfs.nsw.gov.au

**WINDELLAMA PH: 4844 5359 or
CHANNEL 21/209 Base**



AMBULANCE	000
Ambulance Booking	13 12 33
Goulburn Ambo Station	4827 0444

Windellama SES	132 500
Kevin Muffet	4844 7143
Poison Info. Service	13 11 26
Goulburn Base Hospital	4827 3111

Police

Tarago Station -	
Snr. Constable Gary Handshaker	4849 4411
Goulburn	4824 0799

Other

Goulburn Railway Station	4828 5816
Train info & bookings	13 22 32
www.countrylink.info	
Country Energy - interruptions	13 20 80
Lifeline	13 11 14
Kids Helpline	1800 551 800

October 2016

Mon

Tue

Wed

Thu

Fri

Sat

Sun

					1	2
3	4	5	6	7	8	9 St Bart's Service
10 New School Term	11 Craft Afternoon/ Outreach Meeting	12 Progress Meeting	13	14	15	16 Markets
17	18 Craft Afternoon	19	20	21	22 RFS Meeting & Training	23 St Bart's Service
24	25 Craft Afternoon	26 Big READ bus at School	27	28	29	30
31						